



Housings

2023 - 2024



Residential



Commerical



Hydroscientific

**Email Us
for Pricing**

H₂O International Inc.

3001 S.W. 15th St., Suite C, Deerfield Beach, FL 33442

USA Toll-Free: 1-800-570-3464 International: 1-954-570-3464

sales@h2ofilter.com www.h2ofilter.com

Housings

Table Of Contents



Residential

- 1. HF2 Series – Slim Flat Cap Filter Housings**
- 2. HF3 Series – Slim Rib Cap Filter Housings**

Commercial

- 1. HF45 Series – 4,5” OD Commercial Filter Housings**
- 2. HF5 Series – Commercial Filter Housings**
- 3. HF5HT/ HF45HT Series – High Temperature Filter Housings**
- 4. MH03 Series – Membrane Housings**

Hydroscientific

- 1. BF/ MBF Series – Band Clamp & Swing Bolt Bag Housings**
- 2. HBCJ Series – Band Clamp Jumbo Filter Housings**
- 3. HF Series – High Flow Filter Housings**
- 4. HF45SS Series – 4,5” Stainless Steel Single Element Filter Housings**
- 5. HSBJ Series – Swing Bolt Jumbo Filter Housings**
- 6. MRH/ MRHS Series – Swing Bolt Multi Round Filter Housings**
- 7. SC Series – Stainless Steel Filter Housings**
- 8. SPV Series – Stainless Steel Membrane Vessels**
- 9. T Series – Stainless Steel Single Element Filter Housings**
- 10. FRPV Series – Hydron Membrane Housings**

HF2 SERIES

Slim Flat Cap Filter Housings
Data Sheet

HF2 Series

Slim Flat Cap Filter Housings

- ✓ Multiple housing sizes to accept 4 7/8" and 9 7/8" length cartridges
- ✓ Opaque housings are NSF Listed*
- ✓ 1/4", 3/8" and 1/2" female NPT ports standard



HF2 SERIES SLIM FLAT CAP FILTER HOUSINGS

are NSF/ANSI Standard 42 certified for material and structural integrity requirements only.

HF2 SERIES SLIM FLAT CAP FILTER HOUSINGS

are available in a variety of colors and are made to house 2.5" diameter cartridges. Most 4 7/8" and 9 7/8", cartridges fit easily and caps are available in 1/4", 3/8" and 1/2" female NPT ports.

HF2 SERIES SLIM FLAT CAP FILTER HOUSINGS

are ideal for typical applications as pre and post-filtration for RO systems, under sink filters, counter top systems, ice machines, food service and other applications.



This housing is tested and Certified by NSF International against NSF/ANSI Standard 42 for materials and structural integrity requirements.

COMPONENT

* For the complete list of our NSF Certified products, please visit the H2O International Inc. page on the official NSF website: www.nsf.org

HF2 SERIES SPECIFICATIONS							
	Part Number	Description	Case Qty	Box Dimension (Inches)	Weight (lbs)	Weight (kgs)	
5" BODY	HF2-5WHWH14	NSF 5" White Body, White Flat Cap 1/4"	15	8 x 14 x 22	20	9.07	
	HF2-5WHWH38	NSF 5" White Body, White Flat Cap 3/8"	15	8 x 14 x 22	20	9.07	
	HF2-5WHWH12	NSF 5" White Body, White Flat Cap 1/2"	15	8 x 14 x 22	20	9.07	
	HF2-5CLWH14	5" Clear Body, White Flat Cap 1/4"	15	8 x 14 x 22	20	9.07	
	HF2-5CLWH38	5" Clear Body, White Flat Cap 3/8"	15	8 x 14 x 22	20	9.07	
	HF2-5CLWH12	5" Clear Body, White Flat Cap 1/2"	15	8 x 14 x 22	20	9.07	
10" 1/4" PORT	HF2-10WHWH14	NSF 10" White Body, White Flat Cap 1/4"	12	14 x 16 x 21	30	13.61	
	HF2-10BLBK14	NSF 10" Blue Body, Black Flat Cap 1/4"	12	14 x 16 x 21	30	13.61	
	HF2-10CLWH14	10" Clear Body, White Flat Cap 1/4"	12	14 x 16 x 21	30	13.61	
	HF2-10CLBK14	10" Clear Body, Black Flat Cap 1/4"	12	14 x 16 x 21	30	13.61	
10" 3/8" PORT	HF2-10WHWH38	NSF 10" White Body, White Flat Cap 3/8"	12	14 x 16 x 21	30	13.61	
	HF2-10BLBK38	NSF 10" Blue Body, Black Flat Cap 3/8"	12	14 x 16 x 21	30	13.61	
	HF2-10CLWH38	10" Clear Body, White Flat Cap 3/8"	12	14 x 16 x 21	30	13.61	
	HF2-10CLBK38	10" Clear Body, White Flat Cap 3/8"	12	14 x 16 x 21	30	13.61	
10" 1/2" PORT	HF2-10WHWH12	NSF 10" White Body, White Flat Cap 1/2"	12	14 x 16 x 21	30	13.61	
	HF2-10BLBK12	NSF 10" Blue Body, Black Flat Cap 1/2"	12	14 x 16 x 21	30	13.61	
	HF2-10CLWH12	10" Clear Body, White Flat Cap 1/2"	12	14 x 16 x 21	30	13.61	
	HF2-10CLBK12	10" Clear Body, Black Flat Cap 1/2"	12	14 x 16 x 21	30	13.61	
O-Ring	HF2/3 ORING	O-Ring for HF2, 3 Filter Housing	-	-	-	-	

HF2 SERIES

Slim Flat Cap Filter Housings
Data Sheet

Materials of Construction

Opaque Housing:	Polypropylene
Clear Housing:	San
Cap:	Polypropylene
O-Ring:	Buna-N

Operating Data

Maximum Temperature:	125°F (51.7°C)
Maximum Pressure:	75 PSI (5.17 bar)

Applications

- Reverse Osmosis
- Residential Plumbing
- Photography
- Beverage
- Ice maker
- Misting Units

Model # Guide

Filter Housing	Body Length	Cap Color
HF	2-5	WH
	WH	14
	Housing Style	Body Color
		Connection Type

LEGEND

Housing Style: 2 = Slim Flat Cap	Cap Color: WH - White BK - Black
Body/Cartridge Length: 5 = 5" 10 = 10"	Connection Type: 14 = 1/4" 38 = 3/8" 12 = 1/2"
Body Color: WH - White CL - Clear BL - Blue	

Installation Guidelines

WARNING: READ THESE INSTRUCTIONS BEFORE CHANGING OR INSTALLING. FOLLOW THESE INSTRUCTIONS TO REDUCE RISK OF DANGER.

Caution: filter housing must be protected against freezing and extreme temperatures. Filter housings should not be in direct contact with sunlight for a prolonged period of time since uv rays can make housings brittle. Pressure should always be measured before installation and water pressure regulators should be installed in the main line or in front of the housing if water pressure exceeds manufacturers' maximum water pressure: 75 psi. Installers should make sure filters and replacement filters are the correct length and are not too long so as to not cause undo strain and stress on the housing. A leak detector must be installed on all installations where high pressure, water hammer and pressure spikes are known or suspected to be present and on all installations where pressure is over 60 psi. Failure to the above may result in cracking of the filter housing, water leakage and water damage.

Caution: all filtration systems contain other parts that have a limited service life. Exhaustion of the service life of those parts often cannot be easily detected. Commonly, it is only after leakage has been observed or water damage has occurred that one is made aware that the service life has been exhausted.

Important notice: to prevent costly repairs or possible water damage we strongly recommend that the bowl or sump of all plastic housings be replaced periodically: every 5 years for clear sumps, and every 4 years for opaque sumps. If your sump has been in use for more than the recommended period, it should be replaced immediately. Be sure to date any new or replacement sump for future reference and indicate the next recommended replacement date.

Warranty: limited three (3) year warranty from the date of sale for material defects only. Warranty is limited to repair or replacement of product only. Any misuse, mis-installation, lack of maintenance, exceeding maximum pressure or failure to follow these instructions will void limited warranty.

DISCLAIMER OF WARRANTIES. Except as expressly warranted in writing by H2O International Inc., the goods sold by H2O International Inc. are purchased by the buyer "as is." H2O International Inc. does not warrant that the goods are of merchantable quality or that they can be used for any particular purpose. Except as expressly warranted in writing by H2O International Inc., H2O International Inc. makes no representation or warranty of any kind with respect to the products. **LIMITATION OF LIABILITY.** In no event shall H2O International Inc. be liable to the purchaser or any other entity for more than the invoice price received by H2O International Inc. for any non-conforming products. H2O International Inc. shall not be liable to the purchaser or any other entity for personal injury, property damage, or any direct, indirect, special, incidental, consequential, punitive, exemplary, or other damages of any kind, including without limitation the cost of procurement of substitute goods, the loss of profits, products, or production, or the interruption of business, however caused and on any theory of liability, and whether or not H2O International Inc. has been advised of the possibility of such damages. The essential purpose of this provision is to limit the liability of H2O International Inc. arising out of the sale of products to the purchaser whether for breach of contract, negligence, or otherwise. These limitations shall apply notwithstanding any failure of essential purpose of any limited remedy and not withstanding the provisions of any other agreement between H2O International Inc. and the purchaser.

This housing is tested and Certified by NSF International against NSF/ANSI Standard 42 for materials and structural integrity requirements.



Distributed by:



3001 S.W. 15th Street, Suite C, Deerfield Beach, FL 33442
sales@h2ofilter.com • www.h2ofilter.com
Toll-Free Number: 1-800-570-3464
International: 1-954-570-3464

Manufactured by Hydronix Water Technology

HF3 SERIES

Slim Rib Cap Filter Housings
Data Sheet



HF3 Series

Slim Rib Cap Filter Housings

- ✓ Manufactured of reinforced Polypropylene
- ✓ Available in 1/4", 3/8", 1/2" and 3/4" female NPT ports
- ✓ Multiple housing colors and port sizes

HF3 SERIES SLIM RIB CAP FILTER HOUSINGS

are available in a variety of colors and are made to house 2.5" diameter cartridges. Most 4 7/8" and 9 7/8" cartridges fit easily and caps are available in 1/4", 3/8", 1/2" and 3/4" female NPT ports.

HF3 SERIES SLIM RIB CAP FILTER HOUSINGS

are ideal for typical applications as pre and post-filtration for RO systems, under sink filters, counter-top systems, ice machines, food service and other applications.

HF3 SERIES SLIM RIB CAP FILTER HOUSINGS

have pressure relief (PR) buttons available for 1/2" and 1/4" port housings.

HF3 SERIES SPECIFICATIONS						
	Part Number	Description	Case Quantity	Box Dimension (Inches)	Weight (lbs)	Weight (kgs)
5" BODY	HF3-5WHWH14	5" White Body, White Rib Cap 1/4"	15	8 x 14 x 21	13	5.90
	HF3-5WHWH38	5" White Body, White Rib Cap 3/8"	15	8 x 14 x 21	13	5.90
	HF3-5WHWH12	5" White Body, White Rib Cap 1/2"	15	8 x 14 x 21	13	5.90
	HF3-5CLWH14	5" Clear Body, White Rib Cap 1/4"	15	8 x 14 x 21	13	5.90
	HF3-5CLWH38	5" Clear Body, White Rib Cap 3/8"	15	8 x 14 x 21	13	5.90
	HF3-5CLWH12	5" Clear Body, White Rib Cap 1/2"	15	8 x 14 x 21	13	5.90
10" 1/4" PORT	HF3-10WHWH14	10" White Body, White Rib Cap 1/4"	12	8 x 14 x 21	30	13.61
	HF3-10BLBK14	10" Blue Body, Black Rib Cap 1/4"	12	8 x 14 x 21	30	13.61
	HF3-10CLWH14	10" Clear Body, White Rib Cap 1/4"	12	8 x 14 x 21	30	13.61
	HF3-10CLBK14	10" Clear Body, Black Rib Cap 1/4"	12	8 x 14 x 21	30	13.61
10" 3/8" PORT	HF3-10WHWH38	10" White Body, White Rib Cap 3/8"	12	8 x 14 x 21	30	13.61
	HF3-10BLBK38	10" Blue Body, Black Rib Cap 3/8"	12	8 x 14 x 21	30	13.61
	HF3-10CLWH38	10" Clear Body, White Rib Cap 3/8"	12	8 x 14 x 21	30	13.61
	HF3-10CLBK38	10" Clear Body, Black Rib Cap 3/8"	12	8 x 14 x 21	30	13.61
10" 1/2" PORT	HF3-10WHWH12	10" White Body, White Rib Cap 1/2"	12	8 x 14 x 21	30	13.61
	HF3-10WHWH12PR	10" White Body, White Rib Cap 1/2", PR	12	8 x 14 x 21	30	13.61
	HF3-10BLBK12	10" Blue Body, Black Rib Cap 1/2"	12	8 x 14 x 21	30	13.61
	HF3-10BLBK12PR	10" Blue Body, Black Rib Cap 1/2", PR	12	8 x 14 x 21	30	13.61
	HF3-10CLWH12	10" Clear Body, White Rib Cap 1/2"	12	8 x 14 x 21	30	13.61
	HF3-10CLWH12PR	10" Clear Body, White Rib Cap 1/2", PR	12	8 x 14 x 21	30	13.61
	HF3-10CLBK12	10" Clear Body, Black Rib Cap 1/2"	12	8 x 14 x 21	30	13.61
	HF3-10CLBK12PR	10" Clear Body, Black Rib Cap 1/2", PR	12	8 x 14 x 21	30	13.61
10" 3/4" PORT	HF3-10WHWH34	10" White Body, White Rib Cap 3/4"	12	8 x 14 x 21	30	13.61
	HF3-10WHWH34PR	10" White Body, White Rib Cap 3/4", PR	12	8 x 14 x 21	30	13.61
	HF3-10BLBK34	10" Blue Body, Black Rib Cap 3/4"	12	8 x 14 x 21	30	13.61
	HF3-10BLBK34PR	10" Blue Body, Black Rib Cap 3/4", PR	12	8 x 14 x 21	30	13.61
	HF3-10CLWH34	10" Clear Body, White Rib Cap 3/4"	12	8 x 14 x 21	30	13.61
	HF3-10CLWH34PR	10" Clear Body, White Rib Cap 3/4", PR	12	8 x 14 x 21	30	13.61
	HF3-10CLBK34	10" Clear Body, Black Rib Cap 3/4"	12	8 x 14 x 21	30	13.61
	HF3-10CLBK34PR	10" Clear Body, Black Rib Cap 3/4", PR	12	8 x 14 x 21	30	13.61
O-Ring	HF2/3 ORING	O-Ring for HF2, 3 Filter Housing	-	-	-	-

WARNING: Do not use with water that is microbiologically unsafe or of unknown quality without adequate disinfection before or after the system.

HF3 SERIES

Slim Rib Cap Filter Housings
Data Sheet

Materials of Construction

Opaque Housing:	Polypropylene
Clear Housing:	San
Cap:	Polypropylene
O-Ring:	EPDM

Operating Data

Maximum Temperature:	125°F (51.7°C)
Maximum Pressure:	75 PSI (5.17 bar)

Applications

- Reverse Osmosis
- Residential Plumbing
- Photography
- Beverage
- Ice Maker
- Misting Units

Model # Guide

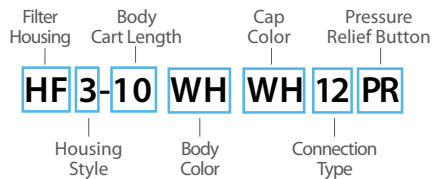

LEGEND

Housing Style:	3 = Slim Rib Cap	Cap Color:	WH - White
Body/Cartridge			BK - Black
Length:	5 = 5"	Connection Type:	14 = 1/4"
	10 = 10"		38 = 3/8"
Body Color:	WH - White		12 = 1/2"
	CL - Clear		34 = 3/4"
	BL - Blue		

Installation Guidelines

WARNING: READ THESE INSTRUCTIONS BEFORE CHANGING OR INSTALLING. FOLLOW THESE INSTRUCTIONS TO REDUCE RISK OF DANGER.

Caution: filter housing must be protected against freezing and extreme temperatures. Filter housings should not be in direct contact with sunlight for a prolonged period of time since uv rays can make housings brittle. Pressure should always be measured before installation and water pressure regulators should be installed in the main line or in front of the housing if water pressure exceeds manufacturers' maximum water pressure: 75 psi. Installers should make sure filters and replacement filters are the correct length and are not too long so as to not cause undo strain and stress on the housing. A leak detector must be installed on all installations where high pressure, water hammer and pressure spikes are known or suspected to be present and on all installations where pressure is over 60 psi. Failure to the above may result in cracking of the filter housing, water leakage and water damage.

Caution: all filtration systems contain other parts that have a limited service life. Exhaustion of the service life of those parts often cannot be easily detected. Commonly, it is only after leakage has been observed or water damage has occurred that one is made aware that the service life has been exhausted.

Important notice: to prevent costly repairs or possible water damage we strongly recommend that the bowl or sump of all plastic housings be replaced periodically: every 5 years for clear sumps, and every 4 years for opaque sumps. If your sump has been in use for more than the recommended period, it should be replaced immediately. Be sure to date any new or replacement sump for future reference and indicate the next recommended replacement date.

Warranty: limited three (3) year warranty from the date of sale for material defects only. Warranty is limited to repair or replacement of product only. Any misuse, misinstallation, lack of maintenance, exceeding maximum pressure or failure to follow these instructions will void limited warranty.

DISCLAIMER OF WARRANTIES. Except as expressly warranted in writing by H2O International Inc., the goods sold by H2O International Inc. are purchased by the buyer "as is." H2O International Inc. does not warrant that the goods are of merchantable quality or that they can be used for any particular purpose. Except as expressly warranted in writing by H2O International Inc. makes no representation or warranty of any kind with respect to the products. LIMITATION OF LIABILITY. In no event shall H2O International Inc. be liable to the purchaser or any other entity for more than the invoice price received by H2O International Inc. for any non-conforming products. H2O International Inc. shall not be liable to the purchaser or any other entity for personal injury, property damage, or any direct, indirect, special, incidental, consequential, punitive, exemplary, or other damages of any kind, including without limitation the cost of procurement of substitute goods, the loss of profits, products, or production, or the interruption of business, however caused and on any theory of liability, and whether or not H2O International Inc. has been advised of the possibility of such damages. The essential purpose of this provision is to limit the liability of H2O International Inc. arising out of the sale of products to the purchaser whether for breach of contract, negligence, or otherwise. These limitations shall apply notwithstanding any failure of essential purpose of any limited remedy and not withstanding the provisions of any other agreement between H2O International Inc. and the purchaser.

Distributed by:



3001 S.W. 15th Street, Suite C, Deerfield Beach, FL 33442
sales@h2ofilter.com • www.h2ofilter.com

Toll-Free Number: 1-800-570-3464

International: 1-954-570-3464

Manufactured by Hydronix Water Technology

HF45 SERIES4.5" OD Commercial Filter Housings
Data Sheet**HF45 Series**

4.5" OD Commercial Filter Housings

- ✓ Available with pressure relief valves
- ✓ Made with durable Polypropylene
- ✓ Ideal for high flow applications

**HF45 SERIES COMMERCIAL FILTER HOUSINGS**

are high durability commercial filter housings for 10" and 20" length cartridges. HF45 Series housings have excellent chemical resistance and are ideal for many high flow residential, commercial and light industrial applications.

HF45 SERIES COMMERCIAL FILTER HOUSINGS

accept 4 1/2" diameter cartridges and feature larger ports to allow for a greater flow of liquid to pass through the housing. They are ideal for your larger capacity filtration needs and are made from durable Polypropylene.



This housing is tested and Certified by NSF International against NSF/ANSI Standard 42 for materials and structural integrity requirements.

COMPONENT

HF45 SERIES SPECIFICATIONS						
	Part Number	Description	Case Quantity	Box Dimension (Inches)	Weight (lbs)	Weight (kgs)
10" 3/4" PORT	HF45-10BLBK34	NSF 10" Blue 4.5" Body, 3/4" Black Cap	6	16 x 24 x 16	37	16.78
	HF45-10BLBK34PR	NSF 10" Blue 4.5" Body, 3/4" Black Cap w/PR	6	16 x 24 x 16	37	16.78
	HF45-10BKBK34	NSF 10" Black 4.5" Body, 3/4" Black Cap	6	16 x 24 x 16	37	16.78
	HF45-10BKBK34PR	NSF 10" Black 4.5" Body, 3/4" Black Cap w/PR	6	16 x 24 x 16	37	16.78
	HF45-10GRBK34PR	NSF 10" Grey 4.5" Body, 3/4" Black Cap w/PR	6	16 x 24 x 16	37	16.78
	HF45-10CLBK34	10" Clear 4.5" Body, 3/4" Black Cap	6	16 x 24 x 16	40	18.14
	HF45-10CLBK34PR	10" Clear 4.5" Body, 3/4" Black Cap w/PR	6	16 x 24 x 16	40	18.14
20" 3/4" PORT	HF45-20BLBK34	NSF 20" Blue 4.5" Body, 3/4" Black Cap	4	16 x 16 x 24	37	16.78
	HF45-20BLBK34PR	NSF 20" Blue 4.5" Body, 3/4" Black Cap w/PR	4	16 x 16 x 24	37	16.78
	HF45-20BKBK34	NSF 20" Black 4.5" Body, 3/4" Black Cap	4	16 x 16 x 24	37	16.78
	HF45-20BKBK34PR	NSF 20" Black 4.5" Body, 3/4" Black Cap w/PR	4	16 x 16 x 24	37	16.78
	HF45-20GRBK34PR	NSF 20" Grey 4.5" Body, 3/4" Black Cap w/PR	4	16 x 16 x 24	37	16.78
	HF45-20CLBK34	20" Clear 4.5" Body, 3/4" Black Cap	4	16 x 16 x 24	40	18.14
	HF45-20CLBK34PR	20" Clear 4.5" Body, 3/4" Black Cap w/PR	4	16 x 16 x 24	40	18.14
10" 1" PORT	HF45-10BLBK10	NSF 10" Blue 4.5" Body, 1" Black Cap	6	16 x 24 x 16	37	16.78
	HF45-10BLBK10PR	NSF 10" Blue 4.5" Body, 1" Black Cap w/PR	6	16 x 24 x 16	37	16.78
	HF45-10BKBK10	NSF 10" Black 4.5" Body, 1" Black Cap	6	16 x 24 x 16	37	16.78
	HF45-10BKBK10PR	NSF 10" Black 4.5" Body, 1" Black Cap w/PR	6	16 x 24 x 16	37	16.78
	HF45-10GRBK10PR	NSF 10" Grey 4.5" Body, 1" Black Cap w/PR	6	16 x 24 x 16	37	16.78
	HF45-10CLBK10	10" Clear 4.5" Body, 1" Black Cap	6	16 x 24 x 16	40	18.14
	HF45-10CLBK10PR	10" Clear 4.5" Body, 1" Black Cap w/PR	6	16 x 24 x 16	40	18.14
20" 1" PORT	HF45-20BLBK10	NSF 20" Blue 4.5" Body, 1" Black Cap	4	16 x 16 x 24	37	16.78
	HF45-20BLBK10PR	NSF 20" Blue 4.5" Body, 1" Black Cap w/PR	4	16 x 16 x 24	37	16.78
	HF45-20BKBK10	NSF 20" Black 4.5" Body, 1" Black Cap	4	16 x 16 x 24	37	16.78
	HF45-20BKBK10PR	NSF 20" Black 4.5" Body, 1" Black Cap w/PR	4	16 x 16 x 24	37	16.78
	HF45-20GRBK10PR	NSF 20" Grey 4.5" Body, 1" Black Cap w/PR	4	16 x 16 x 24	37	16.78
	HF45-20CLBK10	20" Clear 4.5" Body, 1" Black Cap	4	16 x 16 x 24	40	18.14
	HF45-20CLBK10PR	20" Clear 4.5" Body, 1" Black Cap w/PR	4	16 x 16 x 24	40	18.14
10" 1.5" PORT	HF45-10BLBK15	NSF 10" Blue 4.5" Body, 1.5" Black Cap	6	16 x 24 x 16	37	16.78
	HF45-10BLBK15PR	NSF 10" Blue 4.5" Body, 1.5" Black Cap w/PR	6	16 x 24 x 16	37	16.78
	HF45-10CLBK15	10" Clear 4.5" Body, 1.5" Black Cap	6	16 x 24 x 16	40	18.14
20" 1.5" PORT	HF45-20BLBK15	NSF 20" Blue 4.5" Body, 1.5" Black Cap	4	16 x 16 x 24	37	16.78
	HF45-20BLBK15PR	NSF 20" Blue 4.5" Body, 1.5" Black Cap w/PR	4	16 x 16 x 24	37	16.78
	HF45-20CLBK15	20" Clear 4.5" Body, 1.5" Black Cap	4	16 x 16 x 24	40	18.14
	HF45-20CLBK15PR	20" Clear 4.5" Body, 1.5" Black Cap w/PR	4	16 x 16 x 24	40	18.14
O-Ring	HF45-ORING	Hydronix O-ring For HF45 Housing	-	-	-	-

HF45 SERIES

4.5" OD Commercial Filter Housings
Data Sheet

Materials of Construction

Opaque Housing:	Polypropylene
Clear Housing:	Polycarbonate
Cap:	Polypropylene
O-Ring:	Buna-N
Button Assembly:	Stainless Steel, EPDM and Polypropylene

Applications

- Ice makers
- Misting Units
- Food Processing
- Analytical
- Wineries
- Reverse Osmosis
- Residential Plumbing
- Photography
- Commercial Pre-filtration
- Beverage

Operating Data

Maximum Temperature: 100° F (37.7°C)
Maximum Pressure: 90 psi (6.21 bar)

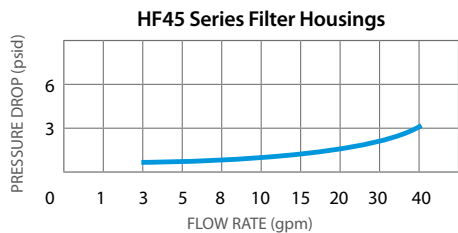

Model # Guide

Filter Housing	Body Cart Length	Cap Color	Pressure Relief Button
HF 45-10	BL	BK	14 PR
Housing Style	Body Color	Connection Type	

LEGEND

Housing Style:	45 = 4.5" OD	Cap Color:	BK - Black
Body Length:	10 = 10"	Connection Type:	34 = 3/4"
	20 = 20"		10 = 1"
Body Color:	CL - Clear		15 = 1/2"
	BL - Blue		
	BK - Black		
	GR - Grey		

Installation Guidelines

WARNING: READ THESE INSTRUCTIONS BEFORE CHANGING OR INSTALLING. FOLLOW THESE INSTRUCTIONS TO REDUCE RISK OF DANGER.

Caution: filter housing must be protected against freezing and extreme temperatures. Filter housings should not be in direct contact with sunlight for a prolonged period of time since uv rays can make housings brittle. Pressure should always be measured before installation and water pressure regulators should be installed in the main line or in front of the housing if water pressure exceeds manufacturers' maximum water pressure: 90 psi. Installers should make sure filters and replacement filters are the correct length and are not too long so as to not cause undo strain and stress on the housing. A leak detector must be installed on all installations where high pressure, water hammer and pressure spikes are known or suspected to be present and on all installations where pressure is over 60 psi. Failure to the above may result in cracking of the filter housing, water leakage and water damage.

Caution: all filtration systems contain other parts that have a limited service life. Exhaustion of the service life of those parts often cannot be easily detected. Commonly, it is only after leakage has been observed or water damage has occurred that one is made aware that the service life has been exhausted.

Important notice: to prevent costly repairs or possible water damage we strongly recommend that the bowl or sump of all plastic housings be replaced periodically: every 5 years for clear sumps, and every 4 years for opaque sumps. If your sump has been in use for more than the recommended period, it should be replaced immediately. Be sure to date any new or replacement sump for future reference and indicate the next recommended replacement date.

Warranty: limited three (3) year warranty from the date of sale for material defects only. Warranty is limited to repair or replacement of product only. Any misuse, misinstallation, lack of maintenance, exceeding maximum pressure or failure to follow these instructions will void limited warranty.

DISCLAIMER OF WARRANTIES. Except as expressly warranted in writing by H2O International Inc., the goods sold by H2O International Inc. are purchased by the buyer "as is." H2O International Inc. does not warrant that the goods are of merchantable quality or that they can be used for any particular purpose. Except as expressly warranted in writing by H2O International Inc. makes no representation or warranty of any kind with respect to the products. **LIMITATION OF LIABILITY.** In no event shall H2O International Inc. be liable to the purchaser or any other entity for more than the invoice price received by H2O International Inc. for any non-conforming products. H2O International Inc. shall not be liable to the purchaser or any other entity for personal injury, property damage, or any direct, indirect, special, incidental, consequential, punitive, exemplary, or other damages of any kind, including without limitation the cost of procurement of substitute goods, the loss of profits, products, or production, or the interruption of business, however caused and on any theory of liability, and whether or not H2O International Inc. has been advised of the possibility of such damages. The essential purpose of this provision is to limit the liability of H2O International Inc. arising out of the sale of products to the purchaser whether for breach of contract, negligence, or otherwise. These limitations shall apply notwithstanding any failure of essential purpose of any limited remedy and not withstanding the provisions of any other agreement between H2O International Inc. and the purchaser.

WARNING: Do not use with water that is microbiologically unsafe or of unknown quality without adequate disinfection before or after the system.

This housing is tested and Certified by NSF International against NSF/ANSI Standard 42 for materials and structural integrity requirements.



*For the complete list of our NSF Certified products, please visit the H2O International Inc. page on the official NSF website: www.nsf.org

Distributed by:



3001 S.W. 15th Street, Suite C, Deerfield Beach, FL 33442
sales@h2ofilter.com • www.h2ofilter.com
Toll-Free Number: 1-800-570-3464
International: 1-954-570-3464

Manufactured by Hydronix Water Technology

HF5 SERIES

Commercial Filter Housings
Data Sheet

HF5 Series

Commercial Filter Housings

- ✓ Available with pressure relief valves (PR)
- ✓ Great for a wide range of applications
- ✓ Opaque housings are NSF Listed*



HF5 SERIES COMMERCIAL FILTER HOUSINGS

are high durability commercial filter housings for 10" and 20" length cartridges.

HF5 SERIES COMMERCIAL FILTER HOUSINGS

have excellent chemical resistance and are ideal for many residential, commercial and light industrial applications.

HF5 SERIES COMMERCIAL FILTER HOUSINGS

are NSF tested and certified to NSF/ANSI Standard 42* for material and structural integrity only.



This housing is tested and Certified by NSF International against NSF/ANSI Standard 42 for materials and structural integrity requirements.

COMPONENT

Applications

- Reverse Osmosis
- Residential Plumbing
- Photography
- Commercial Pre-filtration
- Beverage
- Ice makers
- Misting Units
- Food Processing
- Analytical
- Wineries

Operating Data

Maximum Temp:	125° F (51.7° C)
Maximum Pressure:	100 psi (6.89 bar)
Initial ΔP psi at Flow Rate gpm (lpm):	1 psi at 8 gpm (30.283 l/min)

Materials of Construction

Filter Media:	Polypropylene
Cap:	Polypropylene
Button Assembly:	Stainless steel, EPDM and Polypropylene
O-Ring:	Buna-N

WARNING: Do not use with water that is microbiologically unsafe or of unknown quality without adequate disinfection before or after the system.

* For the complete list of our NSF Certified products, please visit the H2O International Inc. page on the official NSF website: www.nsf.org

HF5 SERIES SPECIFICATIONS						
	Part Number	Description	Case Quantity	Box Dimension (Inches)	Weight (lbs)	Weight (kgs)
10" 3/4" PORT	HF5-10BLBK34	NSF 10" Blue Body, 3/4" Black Rib Cap	12	17 x 22 x 13	38	17.24
	HF5-10BLBK34PR	NSF 10" Blue Body, 3/4" Black Rib Cap w/PR	12	17 x 22 x 13	38	17.24
	HF5-10CLBK34	10" Clear Body, 3/4" Black Rib Cap	12	17 x 22 x 13	38	17.24
	HF5-10CLBK34PR	10" Clear Body, 3/4" Black Rib Cap w/PR	12	17 x 22 x 13	38	17.24
20" 3/4" PORT	HF5-20BLBK34	NSF 20" Blue Body, 3/4" Black Rib Cap	8	12 x 22 x 24	38	17.24
	HF5-20BLBK34PR	NSF 20" Blue Body, 3/4" Black Rib Cap w/PR	8	12 x 22 x 24	38	17.24
	HF5-20CLBK34	20" Clear Body, 3/4" Black Rib Cap	8	12 x 22 x 24	42	19.0
	HF5-20CLBK34PR	20" Clear Body, 3/4" Black Rib Cap w/PR	8	12 x 22 x 24	42	19.05
O-Ring	HF5-ORING	O-Ring for HF5 Filter Housing	-	-	-	-

HF5 SERIES

Commercial Filter Housings
Data Sheet

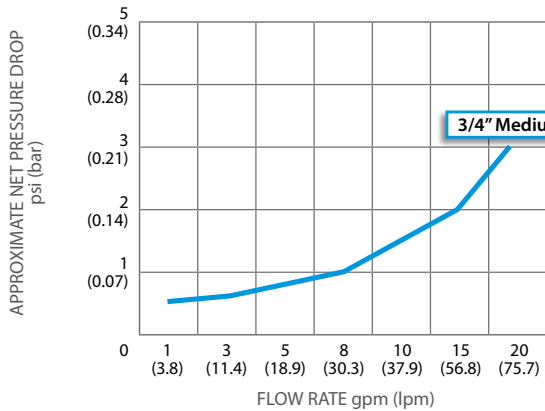
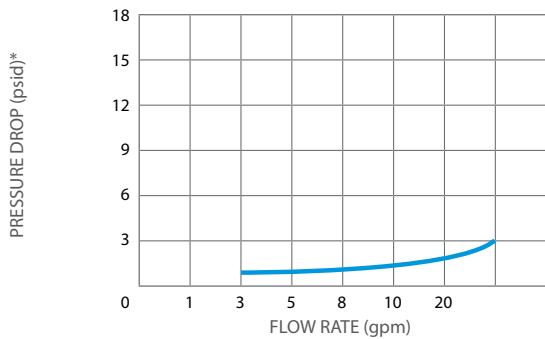

Installation Guidelines

WARNING: READ THESE INSTRUCTIONS BEFORE CHANGING OR INSTALLING. FOLLOW THESE INSTRUCTIONS TO REDUCE RISK OF DANGER.

Caution: filter housing must be protected against freezing and extreme temperatures. Filter housings should not be in direct contact with sunlight for a prolonged period of time since uv rays can make housings brittle. Pressure should always be measured before installation and water pressure regulators should be installed in the main line or in front of the housing if water pressure exceeds manufacturers' maximum water pressure: 100 psi. Installers should make sure filters and replacement filters are the correct length and are not too long so as to not cause undue strain and stress on the housing. A leak detector must be installed on all installations where high pressure, water hammer and pressure spikes are known or suspected to be present and on all installations where pressure is over 60 psi. Failure to the above may result in cracking of the filter housing, water leakage and water damage.

Caution: all filtration systems contain other parts that have a limited service life. Exhaustion of the service life of those parts often cannot be easily detected. Commonly, it is only after leakage has been observed or water damage has occurred that one is made aware that the service life has been exhausted.

Important notice: to prevent costly repairs or possible water damage we strongly recommend that the bowl or sump of all plastic housings be replaced periodically: every 5 years for clear sumps, and every 4 years for opaque sumps. If your sump has been in use for more than the recommended period, it should be replaced immediately. Be sure to date any new or replacement sump for future reference and indicate the next recommended replacement date.

Warranty: limited three (3) year warranty from the date of sale for material defects only. Warranty is limited to repair or replacement of product only. Any misuse, misinstallation, lack of maintenance, exceeding maximum pressure or failure to follow these instructions will void limited warranty.

DISCLAIMER OF WARRANTIES. Except as expressly warranted in writing by H2O International Inc., the goods sold by H2O International Inc. are purchased by the buyer "as is." H2O International Inc. does not warrant that the goods are of merchantable quality or that they can be used for any particular purpose. Except as expressly warranted in writing by H2O International Inc. makes no representation or warranty of any kind with respect to the products. **LIMITATION OF LIABILITY.** In no event shall H2O International Inc. be liable to the purchaser or any other entity for more than the invoice price received by H2O International Inc. for any non-conforming products. H2O International Inc. shall not be liable to the purchaser or any other entity for personal injury, property damage, or any direct, indirect, special, incidental, consequential, punitive, exemplary, or other damages of any kind, including without limitation the cost of procurement of substitute goods, the loss of profits, products, or production, or the interruption of business, however caused and on any theory of liability, and whether or not H2O International Inc. has been advised of the possibility of such damages. The essential purpose of this provision is to limit the liability of H2O International Inc. arising out of the sale of products to the purchaser whether for breach of contract, negligence, or otherwise. These limitations shall apply notwithstanding any failure of essential purpose of any limited remedy and notwithstanding the provisions of any other agreement between H2O International Inc. and the purchaser.

Model # Guide

Filter Housing	Body Cart Length	Cap Color	Pressure Relief Button
HF	5-10	BL	BK 14 PR
Housing Style	Body Color	Connection Type	

LEGEND

Housing Style:	5 = Commercial	Cap Color:	WH - White
Body/Cartridge Length:	10 = 10"		BK - Black
	20 = 20"	Connection Type:	14 = 1/4"
Body Color:	WH - White		38 = 3/8"
	CL - Clear		12 = 1/2"
	BL - Blue		

This housing is tested and Certified by NSF International against NSF/ANSI Standard 42 for materials and structural integrity requirements.



Distributed by:



3001 S.W. 15th Street, Suite C, Deerfield Beach, FL 33442
 sales@h2ofilter.com • www.h2ofilter.com
Toll-Free Number: 1-800-570-3464
International: 1-954-570-3464

Manufactured by Hydronix Water Technology

HF5HT/ HF45HT SERIES

High Temperature Filter Housings
Data Sheet

HF5HT/ HF45HT Series

High Temperature Filter Housings

- ✓ Wide Range of Industrial Uses
- ✓ 3/4" Commercial Style & 1" Big Body Style available
- ✓ Resistant Glass-Reinforced Nylon



HT SERIES HIGH TEMPERATURE FILTER HOUSINGS

are available in 10" & 20" Commercial Style and 10" & 20" Big Body Style. They are ideal for high temperature use and applications involving sea water, organic solvents, alcohol and vegetable oils.

HT SERIES HIGH TEMPERATURE FILTER HOUSINGS

can withstand temperatures up to 165°F and are an economical alternative to Stainless Steel housings.

HF5HT / HF45HT SERIES SPECIFICATIONS		
Part Number	Description	Initial ΔP (psi) at Flow Rate (gpm)
HF5HT-10RDRD34	10" Red Body, 3/4" Red Rib Cap	1 psi at 8 gpm (0.1 bar at 30 L/min) <i>with cold water</i>
HF5HT-20RDRD34	20" Red Body, 3/4" Red Rib Cap	1 psi at 8 gpm (0.1 bar at 30 L/min) <i>with cold water</i>
HF45HT-10RDBK10	10" Red 4.5" Body, 1" Black Cap	1 psi at 15 gpm (0.1 bar at 57 L/min) <i>with cold water</i>
HF45HT-20RDBK10	20" Red 4.5" Body, 1" Black Cap	1 psi at 15 gpm (0.1 bar at 57 L/min) <i>with cold water</i>

* DO NOT use with Ketones.

HF5HT / HF45HT SERIES SPECIFICATIONS						
	Part Number	Description	Case Quantity	Box Dimension (Inches)	Weight (lbs)	Weight (kgs)
10"	HF5HT-10RDRD34	10" Red 2.5" Body, 3/4" Red Rib Cap, High Temp Max 165°F	12	17 x 22 x 13	36	16.33
	HF45HT-10RDBK10	10" Red 4.5" Body, 1" Black Cap High Temp Max 165°F	6	16 x 23 x 14	40	18.14
20"	HF5HT-20RDRD34	20" Red 2.5" Body, 3/4" Red Rib Cap, High Temp Max 165°F	8	12 x 22 x 24	38	17.24
	HF45HT-20RDBK10	20" Red 4.5" Body, 1" Black Cap High Temp Max 165°F	4	16 x 16 x 26	64.5	29.26
	HF45HT-20RDBK15	20" Red 4.5" Body, 1.5" Black Cap High Temp Max 165°F	4	16 x 16 x 26	64.5	29.26
O-Ring	HF5HT-ORING	O-ring For HF5HT Housing	-	-	-	-
	HF45HT-ORING	O-ring For HF45HT Housing	-	-	-	-

Materials of Construction

Housing:	Glass-Reinforced Nylon
Cap:	Glass-Reinforced Nylon
O-Ring:	Viton

Operational Data

Max. Temp:	165°F (73.9°C)
Max. Pressure:	125 psi (8.62 bar)

Applications

- Commercial
- Sea Water
- Organic Solvents
- Industrial
- Alcohol
- Petroleum

Model # Guide

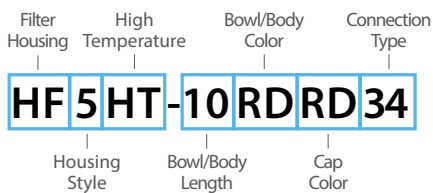

LEGEND

Housing Style:	5 = Commercial 45 = 4.5" Body
Bowl/Body Cart Length:	10 = 10" 20 = 20"
Bowl/Body Color:	RD - Red
Cap Color:	RD - Red BK - Black
Connection Type:	34 = 3/4" 10 = 1"

Installation Guidelines

WARNING: READ THESE INSTRUCTIONS BEFORE CHANGING OR INSTALLING. FOLLOW THESE INSTRUCTIONS TO REDUCE RISK OF DANGER.

Caution: filter housing must be protected against freezing and extreme temperatures. Filter housings should not be in direct contact with sunlight for a prolonged period of time since uv rays can make housings brittle. Pressure should always be measured before installation and water pressure regulators should be installed in the main line or in front of the housing if water pressure exceeds manufacturers' maximum water pressure: 125 psi. Installers should make sure filters and replacement filters are the correct length and are not too long so as to not cause undo strain and stress on the housing. A leak detector must be installed on all installations where high pressure, water hammer and pressure spikes are known or suspected to be present and on all installations where pressure is over 60 psi. Failure to the above may result in cracking of the filter housing, water leakage and water damage.

Caution: all filtration systems contain other parts that have a limited service life. Exhaustion of the service life of those parts often cannot be easily detected. Commonly, it is only after leakage has been observed or water damage has occurred that one is made aware that the service life has been exhausted.

Important notice: to prevent costly repairs or possible water damage we strongly recommend that the bowl or sump of all plastic housings be replaced periodically: every 5 years for clear sumps, and every 4 years for opaque sumps. If your sump has been in use for more than the recommended period, it should be replaced immediately. Be sure to date any new or replacement sump for future reference and indicate the next recommended replacement date.

Warranty: limited three (3) year warranty from the date of sale for material defects only. Warranty is limited to repair or replacement of product only. Any misuse, misinstallation, lack of maintenance, exceeding maximum pressure or failure to follow these instructions will void limited warranty.

DISCLAIMER OF WARRANTIES. Except as expressly warranted in writing by H2O International Inc., the goods sold by H2O International Inc. are purchased by the buyer "as is." H2O International Inc. does not warrant that the goods are of merchantable quality or that they can be used for any particular purpose. Except as expressly warranted in writing by H2O International Inc. makes no representation or warranty of any kind with respect to the products. LIMITATION OF LIABILITY. In no event shall H2O International Inc. be liable to the purchaser or any other entity for more than the invoice price received by H2O International Inc. for any non-conforming products. H2O International Inc. shall not be liable to the purchaser or any other entity for personal injury, property damage, or any direct, indirect, special, incidental, consequential, punitive, exemplary, or other damages of any kind, including without limitation the cost of procurement of substitute goods, the loss of profits, products, or production, or the interruption of business, however caused and on any theory of liability, and whether or not H2O International Inc. has been advised of the possibility of such damages. The essential purpose of this provision is to limit the liability of H2O International Inc. arising out of the sale of products to the purchaser whether for breach of contract, negligence, or otherwise. These limitations shall apply notwithstanding any failure of essential purpose of any limited remedy and notwithstanding the provisions of any other agreement between H2O International Inc. and the purchaser.

Distributed by:



3001 S.W. 15th Street, Suite C, Deerfield Beach, FL 33442
sales@h2ofilter.com • www.h2ofilter.com

Toll-Free Number: 1-800-570-3464

International: 1-954-570-3464

MH03 SERIESMembrane Housings
Data Sheet**MH03 Series***Membrane Housings*

- ✓ Thicker body for strength and durability
- ✓ Accepts most standard residential membranes
- ✓ NSF Standard 58 Certified
- ✓ Dual O-Ring design

**MH03 SERIES MEMBRANE HOUSINGS**

are manufactured with high-quality NSF approved material and will accommodate most standard membrane elements.

MH03 SERIES MEMBRANE HOUSINGS

are NSF Standard 58 certified for use in Reverse Osmosis Water Treatment Systems. MH03 Series membrane housings are available in white and black to meet your system design needs.



Tested and certified by NSF International to ANSI/NSF Standard 58 for material requirements only.

MH03 SERIES SPECIFICATIONS						
	Part Number	Description	Case Quantity	Box Dimension (in)	Weight (lbs)	Weight (kgs)
Housing	MH03-1812WH	NSF, 1.8" x 12" Membrane Housing White	24	17 x 13 x 14	26	11.79
	MH03-1812WH-QC	1.8" X 12" Membrane Housing White, Hydrofit™ QC, Double O-Ring	30	20 x 15 x 30	33	14.97
	MH03-3012	3" X 12" Membrane Housing White	15	13 x 14 x 23	29	13.15
O-Ring	MH03-ORING	O-Ring for MH03 Housing	100	-	-	-
	MH03-CAPORING	MH03 Housing Cap O-Ring	100	-	-	-

Materials of Construction

Housing:	Polypropylene
Cap:	Polypropylene
O-ring:	EPDM

Operating Data

Max. Temp:	125°F (51.7°C)
Max. Pressure:	100 psi (7 bar)

Product Features

- FDA approved material
- 90° angle outlet
- 1/8" NPT thread ports

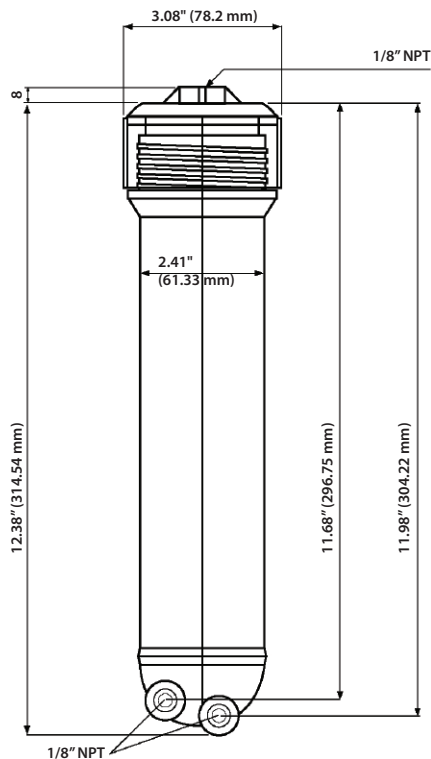

Installation Guidelines

WARNING: READ THESE INSTRUCTIONS BEFORE CHANGING OR INSTALLING. FOLLOW THESE INSTRUCTIONS TO REDUCE RISK OF DANGER.

Caution: filter housing must be protected against freezing and extreme temperatures. Filter housings should not be in direct contact with sunlight for a prolonged period of time since uv rays can make housings brittle. Pressure should always be measured before installation and water pressure regulators should be installed in the main line or in front of the housing if water pressure exceeds manufacturers' maximum water pressure: 75 psi. Installers should make sure filters and replacement filters are the correct length and are not too long so as to not cause undo strain and stress on the housing. A leak detector must be installed on all installations where high pressure, water hammer and pressure spikes are known or suspected to be present and on all installations where pressure is over 60 psi. Failure to the above may result in cracking of the filter housing, water leakage and water damage.

Caution: all filtration systems contain other parts that have a limited service life. Exhaustion of the service life of those parts often cannot be easily detected. Commonly, it is only after leakage has been observed or water damage has occurred that one is made aware that the service life has been exhausted.

Important notice: to prevent costly repairs or possible water damage we strongly recommend that the bowl or sump of all plastic housings be replaced periodically: every 5 years for clear sumps, and every 4 years for opaque sumps. If your sump has been in use for more than the recommended period, it should be replaced immediately. Be sure to date any new or replacement sump for future reference and indicate the next recommended replacement date.

Warranty: limited three (3) year warranty from the date of sale for material defects only. Warranty is limited to repair or replacement of product only. Any misuse, misinstallation, lack of maintenance, exceeding maximum pressure or failure to follow these instructions will void limited warranty.

DISCLAIMER OF WARRANTIES. Except as expressly warranted in writing by hydronix water technology, the goods sold by hydronix water technology are purchased by the buyer "as is." Hydronix water technology does not warrant that the goods are of merchantable quality or that they can be used for any particular purpose. Except as expressly warranted in writing by hydronix water technology, hydronix water technology makes no representation or warranty of any kind with respect to the products.

LIMITATION OF LIABILITY. In no event shall hydronix water technology be liable to the purchaser or any other entity for more than the invoice price received by hydronix water technology for any non-conforming products. Hydronix water technology shall not be liable to the purchaser or any other entity for personal injury, property damage, or any direct, indirect, special, incidental, consequential, punitive, exemplary, or other damages of any kind, including without limitation the cost of procurement of substitute goods, the loss of profits, products, or production, or the interruption of business, however caused and on any theory of liability, and whether or not hydronix water technology has been advised of the possibility of such damages. The essential purpose of this provision is to limit the liability of hydronix water technology arising out of the sale of products to the purchaser whether for breach of contract, negligence, or otherwise. These limitations shall apply notwithstanding any failure of essential purpose of any limited remedy and notwithstanding the provisions of any other agreement between hydronix water technology and the purchaser.

WARNING: Do not use with water that is microbiologically unsafe or of unknown quality without adequate disinfection before or after the system.

Distributed by:



3001 S.W. 15th Street, Suite C, Deerfield Beach, FL 33442
sales@h2ofilter.com • www.h2ofilter.com

Toll-Free Number: 1-800-570-3464

International: 1-954-570-3464

Manufactured by Hydronix Water Technology



BF/MBF SERIES

Band Clamp & Swing Bolt Bag Housings
Data Sheet

- Band Clamp or Swing Bolt Design.
- 304 or 316 Stainless Steel.
- Electropolish standard on all models.
- Single and Multi-Bag Filter Housing Options.
- Positive O-Ring Seal.
- 150 psi Pressure Rating.
- Accepts #1 (7" x 16-1.2") or #2 (7" x 32") Filter Bags.
- NSF/ANSI/CAN 61 & NSF/ANSI 372 certified.

HYDROSCIENTIFIC™ BF/MBF SERIES BAG FILTER HOUSINGS are ideal for most commercial/industrial applications. Commonly used for pre-filtration for Reverse Osmosis (RO) systems, food service, car washes, agriculture and many other uses.

HYDROSCIENTIFIC™ BF/MBF SERIES BAG FILTER HOUSINGS are made with high grade 304 or 316 Stainless Steel and easily accept most standard filter bags. With a wide range of models, these housings can easily meet most application requirements.



This filter cartridge is tested and certified by NSF International to NSF/ANSI/CAN 61, NSF/ANSI 372.

COMPONENT



BF SERIES - 304SS AND 316SS BAND CLAMP SINGLE BAG HOUSING (#1, #2, #3 AND #4) SPECIFICATIONS

Part Number	Description	Ports (In/Out)	Drains (FNPT)	Vents (FNPT)	Gauge Ports	Max. Flow (gpm)	Max. Flow (lpm)	Max. Flow (m ³ /hr)
BF1-304-2NBC	HydroScientific™ BC Single Bag Housing, 1 x #1, 304SS, AL, EP	2" FNPT	-	1/4" FNPT	1/4" FNPT	90	340	20
BF2-304-2NBC	HydroScientific™ BC Single Bag Housing, 1 x #2, 304SS, AL, EP	2" FNPT	-	1/4" FNPT	1/4" FNPT	200	757	45
BF3-304-1NBC	HydroScientific™ BC Single Bag Housing, 1 x #3, 304SS, AL, EP	1" FNPT	-	1/4" FNPT	1/4" FNPT	20	76	4.5
BF4-304-1NBC	HydroScientific™ BC Single Bag Housing, 1 x #4, 304SS, AL, EP	1" FNPT	-	1/4" FNPT	1/4" FNPT	45	170	10
BF1-316-2NBC	HydroScientific™ BC Single Bag Housing, 1 x #1, 316SS, AL, EP	2" FNPT	-	1/4" FNPT	1/4" FNPT	90	340	20
BF2-316-2NBC	HydroScientific™ BC Single Bag Housing, 1 x #2, 316SS, AL, EP	2" FNPT	-	1/4" FNPT	1/4" FNPT	200	757	45
BF3-316-1NBC	HydroScientific™ BC Single Bag Housing, 1 x #3, 316SS, AL, EP	1" FNPT	-	1/4" FNPT	1/4" FNPT	20	76	4.5
BF4-316-1NBC	HydroScientific™ BC Single Bag Housing, 1 x #4, 316SS, AL, EP	1" FNPT	-	1/4" FNPT	1/4" FNPT	45	170	10

BF SERIES - 304SS AND 316SS SWING BOLT SINGLE BAG HOUSING (#1 AND #2) SPECIFICATIONS

Part Number	Description	Ports (In/Out)	Drains (FNPT)	Vents (FNPT)	Gauge Ports	Max. Flow (gpm)	Max. Flow (lpm)	Max. Flow (m ³ /hr)
BF1-304-2N	HydroScientific™ SB Single Bag Housing, 1 x #1, 304SS, AL, EP	2" FNPT	-	1/4" FNPT	1/4" FNPT	90	340	20
BF2-304-2N	HydroScientific™ SB Single Bag Housing, 1 x #2, 304SS, AL, EP	2" FNPT	-	1/4" FNPT	1/4" FNPT	200	757	45
BF1-316-2N	HydroScientific™ SB Single Bag Housing, 1 x #1, 316SS, AL, EP	2" FNPT	-	1/4" FNPT	1/4" FNPT	90	340	20
BF2-316-2N	HydroScientific™ SB Single Bag Housing, 1 x #2, 316SS, AL, EP	2" FNPT	-	1/4" FNPT	1/4" FNPT	200	757	45

BF SERIES - CARBON STEEL SWING BOLT SINGLE BAG HOUSING (#1 AND #2) SPECIFICATIONS

Part Number	Description	Ports (In/Out)	Drains (FNPT)	Vents (FNPT)	Gauge Ports	Max. Flow (gpm)	Max. Flow (lpm)	Max. Flow (m ³ /hr)
BF1-C-2N	HydroScientific™ SB Single Bag Housing, 1 x #1, CS, AL, EP	2" FNPT	-	1/4" FNPT	1/4" FNPT	90	340	20
BF2-C-2N	HydroScientific™ SB Single Bag Housing, 1 x #2, CS, AL, EP	2" FNPT	-	1/4" FNPT	1/4" FNPT	200	757	45

BC = BAND CLAMP, SB = SWING BOLT, CS = CARBON STEEL, AL = ADJUSTABLE LEGS, EP = ELECTROPOLISH

MBF SERIES - 304SS SWING BOLT MULTI BAG HOUSING SPECIFICATIONS

Part Number	Description	Ports (In/Out)	Drains (FNPT)	Vents (FNPT)	Gauge Ports (FNPT)	Swing Arm	Max. Flow (gpm)	Max. Flow (lpm)	Max. Flow (m ³ /hr)
MBF2-304-3F	HydroScientific™ SB Multi Bag Housing, 2 x #2, ML, EP	3" FL	2"	1/2"	1/2"	✓	396	1499	90
MBF3-304-4F	HydroScientific™ SB Multi Bag Housing, 3 x #2, ML, EP	4" FL	2"	1/2"	1/2"	✓	594	2249	135
MBF4-304-4F	HydroScientific™ SB Multi Bag Housing, 4 x #2, ML, EP	4" FL	2"	1/2"	1/2"	✓	793	3002	180
MBF5-304-6F	HydroScientific™ SB Multi Bag Housing, 5 x #2, ML, EP	6" FL	2"	1/2"	1/2"	✓	991	3751	225
MBF6-304-6F	HydroScientific™ SB Multi Bag Housing, 6 x #2, ML, EP	6" FL	2"	1/2"	1/2"	✓	1189	4501	270
MBF8-304-8F	HydroScientific™ SB Multi Bag Housing, 8 x #2, ML, EP	8" FL	2"	1/2"	1/2"	✓	1585	6000	360
MBF12-304-8F	HydroScientific™ SB Multi Bag Housing, 12 x #2, ML, EP	8" FL	2"	1/2"	1/2"	✓	2378	9002	540
MBF12-304-10F	HydroScientific™ SB Multi Bag Housing, 12 x #2, ML, EP	10" FL	2"	1/2"	1/2"	✓	2378	9002	540

MBF SERIES - 316SS SWING BOLT MULTI BAG HOUSING SPECIFICATIONS

Part Number	Description	Ports (In/Out)	Drains (FNPT)	Vents (FNPT)	Gauge Ports (FNPT)	Swing Arm	Max. Flow (gpm)	Max. Flow (lpm)	Max. Flow (m ³ /hr)
MBF2-316-3F	HydroScientific™ SB Multi Bag Housing, 2 x #2, ML, EP	3" FL	2"	1/2"	1/2"	✓	396	1499	90
MBF3-316-4F	HydroScientific™ SB Multi Bag Housing, 3 x #2, ML, EP	4" FL	2"	1/2"	1/2"	✓	594	2249	135
MBF4-316-4F	HydroScientific™ SB Multi Bag Housing, 4 x #2, ML, EP	4" FL	2"	1/2"	1/2"	✓	793	3002	180
MBF5-316-6F	HydroScientific™ SB Multi Bag Housing, 5 x #2, ML, EP	6" FL	2"	1/2"	1/2"	✓	991	3751	225
MBF6-316-6F	HydroScientific™ SB Multi Bag Housing, 6 x #2, ML, EP	6" FL	2"	1/2"	1/2"	✓	1189	4501	270
MBF8-316-8F	HydroScientific™ SB Multi Bag Housing, 8 x #2, ML, EP	8" FL	2"	1/2"	1/2"	✓	1585	6000	360
MBF12-316-8F	HydroScientific™ SB Multi Bag Housing, 12 x #2, ML, EP	8" FL	2"	1/2"	1/2"	✓	2378	9002	540
MBF12-316-10F	HydroScientific™ SB Multi Bag Housing, 12 x #2, ML, EP	10" FL	2"	1/2"	1/2"	✓	2378	9002	540

SB = SWING BOLT, ML = LEGS, EP = ELECTROPOLISH, FL = FLANGE

ADDITIONAL FEATURES

Finish:	Electropolished and Bead Blasted Standard
Drains:	Clean and Dirty standard on all models
Gauge Ports:	Clean and Dirty standard on all models

APPLICATIONS

- Liquid Process
- Food and Beverage
- Chemicals
- Oil / Gas Industry
- Coolants
- Inks / Coatings / Paints
- Wastewater

MATERIALS OF CONSTRUCTION

Housing Shell:	304 or 316 stainless steel
Band Clamp Lid Closure:	304 or 316 stainless steel
Swing Bolt Lid Closure:	Zinc Plated Steel
Vent and Drain Plugs:	304 or 316 stainless steel
Heavy Duty Mounting Legs:	304 or 316 stainless steel
O-Ring / Gasket:	EPDM - FDA Grade (Viton, Silicone and EPR Options)

For the complete list of our NSF Certified products, please visit the H2O International Inc. page on the official NSF website: www.nsf.org

Copyright © 2022 HydroScientific., All Rights Reserved.

OPERATIONAL DATA

Max. Working Pressure:	150 psi at 250 °F (10.3 bar at 121 °C) - Band Clamp 150 psi at 300 °F (10.3 bar at 149 °C) - Swing Bolt
Max. Operating Temperature:	250 °F (121 °C) - Band Clamp 300 °F (149 °C) - Swing Bolt

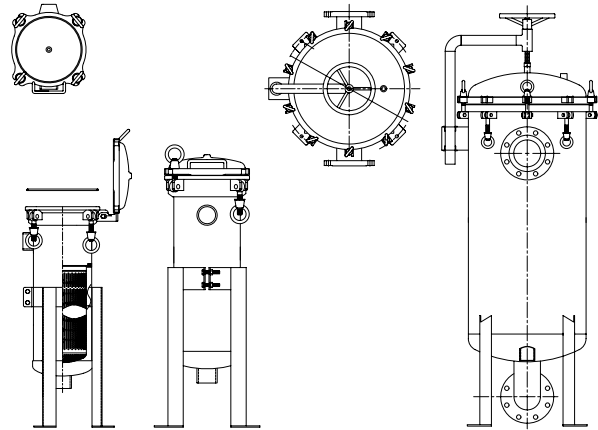

Distributed by:



3001 S.W. 15th Street, Suite C, Deerfield Beach, FL 33442
 sales@h2ofilter.com • www.h2ofilter.com
Toll-Free Number: 1-800-570-3464
International: 1-954-570-3464

Manufactured by Hydronix Water Technology



BAND CLAMP JUMBO FILTER HOUSINGS

HBCJ SERIES



HYDROSCIENTIFIC™ BAND CLAMP JUMBO FILTER HOUSINGS provide exceptional performance and deliver durability, quality and price.

HYDROSCIENTIFIC™ BAND CLAMP JUMBO FILTER HOUSINGS come with Stainless Steel standpipes as a standard feature and through their JUMBO radial flow water entry, water enters the housing and forces water more effectively through the cartridges pleated filter media.



HBCJ SERIES - 304SS BAND CLAMP JUMBO FILTER HOUSING SPECIFICATIONS

Part Number	Description	Ports (In/Out)	Drains	Vents	Max. Flow Rate (gpm)
HBCJ40	HydroScientific™ Band Clamp 40 Jumbo Filter Housing, ML, EP	2" FNPT	1" FNPT	1/4" FNPT	50
HBCJ90	HydroScientific™ Band Clamp 90 Jumbo Filter Housing, ML, EP	2" FNPT	1" FNPT	1/4" FNPT	100
HBCJ170	HydroScientific™ Band Clamp 170 Jumbo Filter Housing, ML, EP	2" FNPT	1" FNPT	1/4" FNPT	150

HBCJ SERIES - 316SS BAND CLAMP JUMBO FILTER HOUSING SPECIFICATIONS

Part Number	Description	Ports (In/Out)	Drains	Vents	Max. Flow Rate (gpm)
HBCJ40-316	HydroScientific™ Band Clamp 40 Jumbo Filter Housing, ML, EP	2" FNPT	1" FNPT	1/4" FNPT	50
HBCJ90-316	HydroScientific™ Band Clamp 90 Jumbo Filter Housing, ML, EP	2" FNPT	1" FNPT	1/4" FNPT	100
HBCJ170-316	HydroScientific™ Band Clamp 170 Jumbo Filter Housing, ML, EP	2" FNPT	1" FNPT	1/4" FNPT	150

ML = LEGS, EP = ELECTROPOLISH

BAND CLAMP JUMBO FILTER HOUSINGS

HBCJ SERIES



APPLICATIONS

- Residential, Commercial and Industrial
- Cooling Tower Filtration
- Whole House Filtration
- Process Water
- Well Water
- Small Community Compliance
- Industrial Waste Water Treatment

FEATURES

- 304 or 316 Stainless Steel.
- Electropolished standard on all models.
- Band Clamp Design for Fast / Easy / Safe Operation.
- Stainless Steel Standpipe.
- Accepts Jumbo Style Cartridges.
- Multiple Size options to best meet your application.

ADDITIONAL FEATURES

Finish: Electropolished and Bead Blasted Standard
 Drains: Clean and Dirty standard on all models

MATERIALS OF CONSTRUCTION

Housing Shell: 304 or 316 Stainless Steel
 Band Clamp Lid Closure: 304 or 316 Stainless Steel
 Vent and Drain Plugs: 304 or 316 Stainless Steel
 Heavy Duty Mounting Legs: 304 or 316 Stainless Steel
 O-Ring/Gasket: EPDM - FDA Grade
 (Viton, Silicone and EPR Options)

OPERATIONAL DATA

Max. Working Pressure: 150 psi at 250°F (10.3 bar at 121°C)
 Max. Operating Temperature: 250 °F (121 °C)

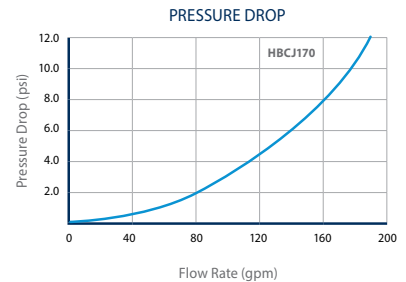
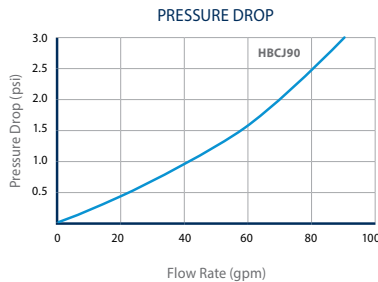
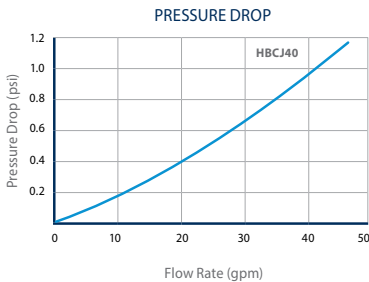
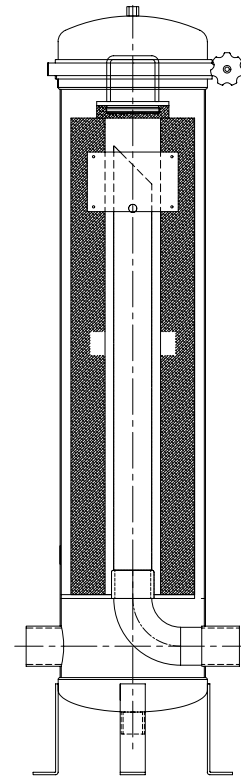
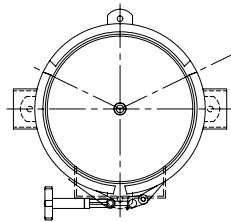



HIGH FLOW FILTER HOUSINGS

HF SERIES



HYDROSCIENTIFIC™ HF SERIES HIGH FLOW FILTER HOUSINGS

are ideal for most industrial/commercial applications and are commonly used for pre-filtration for Reverse Osmosis (RO) systems, food service, car washes, and many other applications where high flow operation is required.

HYDROSCIENTIFIC™ HF SERIES HIGH FLOW FILTER HOUSINGS

are made with a high grade 304 or 316 Stainless Steel, are available in numerous mounting configurations and accept various High Flow Filter Cartridges.



HF SERIES - 304 SS BAND CLAMP AND SWING BOLT HIGH FLOW HOUSING SPECIFICATIONS

Part Number	Description	Ports (In/Out)	Style	Max. Flow (gpm)	Max. Flow (lpm)	Max. Flow (m ³ /hr)
HFE-304	HydroScientific™ BC Economy 23" Single High Flow Filter Housing, MT, Buna N, EP	2" FNPT	V	100	378	23
HF2V-304-2F	HydroScientific™ SB 20" Single High Flow Filter Housing, ML, GP, EP	2" FL	V	100	378	23
HF4V-304-3F	HydroScientific™ SB 40" Single High Flow Filter Housing, ML, GP, EP	3" FL	V	250	946	57
HF4H-304-3F	HydroScientific™ SB 40" Single High Flow Filter Housing, ML, GP, EP	3" FL	H	250	946	57
HF6H-304-3F	HydroScientific™ SB 60" Single High Flow Filter Housing, ML, GP, EP	3" FL	H	300	1136	68
HF4H-304-6F3	HydroScientific™ SB 3 x 40" Multi High Flow Filter Housing, ML, GP, EP	6" FL	H	800	3028	182
HF6H-304-6F3	HydroScientific™ SB 3 x 60" Multi High Flow Filter Housing, ML, GP, EP	6" FL	H	900	3407	204
HF4H-304-6F4	HydroScientific™ SB 4 x 40" Multi High Flow Filter Housing, ML, GP, EP	6" FL	H	1100	4164	250
HF6H-304-6F4	HydroScientific™ SB 4 x 60" Multi High Flow Filter Housing, ML, GP, EP	6" FL	H	1200	4542	272
HF4H-304-8F7	HydroScientific™ SB 7 x 40" Multi High Flow Filter Housing, ML, GP, EP	8" FL	H	1800	6814	409
HF6H-304-8F7	HydroScientific™ SB 7 x 60" Multi High Flow Filter Housing, ML, GP, EP	8" FL	H	2500	9464	568
HF4H-304-12F12	HydroScientific™ SB 12 x 40" Multi High Flow Filter Housing, ML, GP, EP	12" FL	H	3000	11356	681
HF6H-304-12F12	HydroScientific™ SB 12 x 60" Multi High Flow Filter Housing, ML, GP, EP	12" FL	H	3600	13627	818

BC = BAND CLAMP, SB = SWING BOLT, ML = LEGS, MT = MOUNTING TABS, GP = GAUGE PORT, EP = ELECTROPOLISH, FL = FLANGE, V = VERTICAL, H = HORIZONTAL

HIGH FLOW FILTER HOUSINGS

HF SERIES



HF SERIES - 316 SS BAND CLAMP AND SWING BOLT HIGH FLOW HOUSING SPECIFICATIONS							
Part Number	Description	Ports (In/Out)	Style	Max. Flow (gpm)	Max. Flow (lpm)	Max. Flow (m ³ /hr)	
HF316	HydroScientific™ BC Economy 23" Single High Flow Filter Housing, MT, Buna N, GP, EP	2" FNPT	V	100	378	23	
HF2V-316-2F	HydroScientific™ SB 20" Single High Flow Filter Housing, ML, GP, EP	2" FL	V	100	378	23	
HF4V-316-3F	HydroScientific™ SB 40" Single High Flow Filter Housing, ML, GP, EP	3" FL	V	250	946	57	
HF4H-316-3F	HydroScientific™ SB 40" Single High Flow Filter Housing, ML, GP, EP	3" FL	H	250	946	57	
HF6H-316-3F	HydroScientific™ SB 60" Single High Flow Filter Housing, ML, GP, EP	3" FL	H	300	1136	68	
HF4H-316-6F3	HydroScientific™ SB 3 x 40" Multi High Flow Filter Housing, ML, GP, EP	6" FL	H	800	3028	182	
HF6H-316-6F3	HydroScientific™ SB 3 x 60" Multi High Flow Filter Housing, ML, GP, EP	6" FL	H	900	3407	204	
HF4H-316-6F4	HydroScientific™ SB 4 x 40" Multi High Flow Filter Housing, ML, GP, EP	6" FL	H	1100	4164	250	
HF6H-316-6F4	HydroScientific™ SB 4 x 60" Multi High Flow Filter Housing, ML, GP, EP	6" FL	H	1200	4542	272	
HF4H-316-8F7	HydroScientific™ SB 7 x 40" Multi High Flow Filter Housing, ML, GP, EP	8" FL	H	1800	6814	409	
HF6H-316-8F7	HydroScientific™ SB 7 x 60" Multi High Flow Filter Housing, ML, GP, EP	8" FL	H	2500	9464	568	
HF4H-316-12F12	HydroScientific™ SB 12 x 40" Multi High Flow Filter Housing, ML, GP, EP	12" FL	H	3000	11356	681	
HF6H-316-12F12	HydroScientific™ SB 12 x 60" Multi High Flow Filter Housing, ML, GP, EP	12" FL	H	3600	13627	818	

BC = BAND CLAMP, SB = SWING BOLT, ML = LEGS, MT = MOUNTING TABS, GP = GAUGE PORT, EP = ELECTROPOLISH, FL = FLANGE, V = VERTICAL, H = HORIZONTAL

APPLICATIONS

- Residential, Commercial and Industrial
- Cooling Tower Filtration
- Whole House Filtration
- Process Water
- Well Water
- Industrial Waste Water Treatment

FEATURES

- Electropolished 304 or 316 Stainless Steel.
- Band Clamp or Swing Bolt Design for Fast/Easy Operation.
- Accepts High Flow Cartridges.
- Multiple Size options to best meet your application.
- Horizontal and Vertical options.

Copyright © 2021 HydroScientific., All Rights Reserved.

MATERIALS OF CONSTRUCTION

Housing: 304 or 316 Stainless Steel
 Closure: Stainless Steel
 O-Ring: EPDM (FDA Grade)

OPERATIONAL DATA

Max. Working Pressure: 150 psi at 250 °F (10.3 bar at 121 °C)
 Max. Operating Temperature: 250 °F (121 °C)

PORT DIMENSIONS

Vents: 1/4" and 1/2" NPT
 Drain: 1/2" and 1" NPT
 Inlet: 2" NPT, 3" through 12" Flange
 Outlet: 2" NPT, 3" through 12" Flange

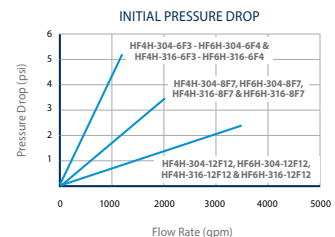
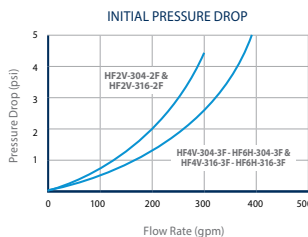
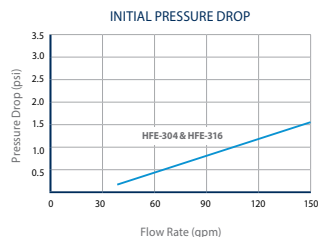



4.5" STAINLESS STEEL SINGLE ELEMENT FILTER HOUSINGS

HF45SS SERIES



HYDROSCIENTIFIC™ SS SINGLE CARTRIDGE HOUSINGS

are ideal for commercial and industrial filter application. Made with Heavy duty 304 or 316 stainless steel construction for maximum durability, HF45SS Series housings accept 4 1/2" diameter (Big Blue style) Double Open-End (DOE) cartridges. Designed for high temperature and high-pressure applications, the HF45SS series housings ring nut closure provides quick cartridge change outs.

HYDROSCIENTIFIC™ SS SINGLE CARTRIDGE HOUSINGS

incorporate a spring-loaded knife edge seal into the housings, this provides positive sealing for variable length cartridges. Numerous gasket options are available for compatibility with most fluids.



HF45SS SERIES - 304 SS SINGLE CARTRIDGE HOUSINGS SPECIFICATIONS

Part Number	Description	Ports (In/Out)	Drains
HF4510SS-10	HydroScientific™ 10" Single Filter Housing, accepts 4.5" x 10" Filter Cartridge	1" FNPT	1/4" FNPT
HF4520SS-10	HydroScientific™ 20" Single Filter Housing, accepts 4.5" x 20" Filter Cartridge	1" FNPT	1/4" FNPT

HF45SS SERIES - 316 SS SINGLE CARTRIDGE HOUSINGS SPECIFICATIONS

Part Number	Description	Ports (In/Out)	Drains
HF4510SS-10-316	HydroScientific™ 10" Single Filter Housing, accepts 4.5" x 10" Filter Cartridge	1" FNPT	1/4" FNPT
HF4520SS-10-316	HydroScientific™ 20" Single Filter Housing, accepts 4.5" x 20" Filter Cartridge	1" FNPT	1/4" FNPT

4.5" STAINLESS STEEL SINGLE ELEMENT FILTER HOUSINGS

HF45SS SERIES



FEATURES

- Spring loaded Knife Edge Seal.
- Commercial and Industrial Filter Application.
- Ring Nut Closure for Quick Cartridge Change Outs.
- High Temperature and High-Pressure Applications.
- Heavy Duty 304 or 316 Stainless Steel Construction.
- Accepts 4 1/2" diameter (Big Blue style) Double Open-End (DOE) cartridges.
- 1/4" FNPT Drain Port Standard.

APPLICATIONS

- Chemicals
- Electronics
- Wastewater
- Potable Water
- Food & Beverage
- RO Prefiltration
- Plating Solutions
- Coolants / Inks / Paints / Coatings
- Photographic Solutions

PORT DIMENSIONS

Drain: 1/4" FNPT
 Inlet: 1" FNPT
 Outlet: 1" FNPT

MATERIALS OF CONSTRUCTION

Body: 304 or 316 Stainless Steel
 Head: 304 or 316 Stainless Steel
 O-Ring: EPDM

OPERATIONAL DATA

Max. Working Pressure: 300 psi (20.68 bar)
 Max. Operating Temperature: 200 °F (93 °C)

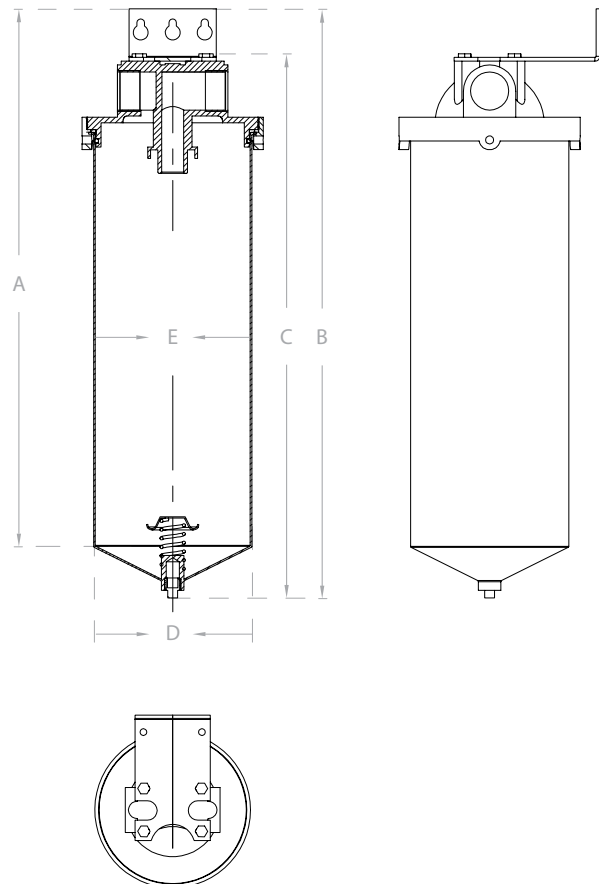

HF45SS SERIES DIMENSIONS

MODEL	A Length	B Length	C Length	D OD Diameter	E ID Diameter
10"	13.58"	18.62"	16.97"	4.89"	4.82"
20"	23.58"	28.62"	26.97"	4.89"	4.82"

Copyright © 2021 HydroScientific., All Rights Reserved.



SWING BOLT JUMBO FILTER HOUSINGS

HSBJ SERIES



HYDROSCIENTIFIC™ SWING BOLT JUMBO FILTER HOUSINGS provide an exceptional performance that delivers durability, quality and price.

HYDROSCIENTIFIC™ SWING BOLT JUMBO FILTER HOUSINGS come with Stainless Steel standpipes as a standard feature and through their JUMBO radial flow water entry, water enters the housing and forces water more effectively through the cartridges pleated filter media.



HSBJ SERIES - 304SS SWING BOLT JUMBO FILTER HOUSING SPECIFICATIONS

Part Number	Description	Ports (In/Out)	Drains (FNPT)	Vents (FNPT)	Gauge Port (FNPT)	Swing Arm	Max. Flow (gpm)	Max. Flow (lpm)	Max. Flow (m ³ /hr)
HSBJ40	HydroScientific™ SB 40 Jumbo Filter Housing, ML, EP	2" FNPT	1"	1/4"	-	-	50	189	12
HSBJ90	HydroScientific™ SB 90 Jumbo Filter Housing, ML, EP	2" FNPT	1"	1/4"	-	-	100	378	24
HSBJ170	HydroScientific™ SB 170 Jumbo Filter Housing, ML, EP	2" FNPT	1"	1/4"	-	-	150	568	36
HSBJ170SB-3	HydroScientific™ SB 3 x 170 Jumbo Filter Housing, ML, EP	4" FL	11/2"	1/2"	1/2"	-	450	1703	102
HSBJ170SB-4	HydroScientific™ SB 4 x 170 Jumbo Filter Housing, ML, EP	6" FL	11/2"	1/2"	1/2"	-	600	2271	144
HSBJ170SB-5	HydroScientific™ SB 5 x 170 Jumbo Filter Housing, ML, EP	6" FL	11/2"	1/2"	1/2"	-	750	2839	170
HSBJ170SB-8	HydroScientific™ SB 8 x 170 Jumbo Filter Housing, ML, EP	6" FL	11/2"	1/2"	1/2"	-	1200	4542	272
HSBJ170SB-12	HydroScientific™ SB 12 x 170 Jumbo Filter Housing, ML, GB	12" FL	11/2"	1/2"	1/2"	✓	1800	6814	432
HSBJ170SB-16	HydroScientific™ SB 16 x 170 Jumbo Filter Housing, ML, GB	12" FL	2"	1/2"	1/2"	✓	2400	9085	576

HSBJ SERIES - 316SS SWING BOLT JUMBO FILTER HOUSING SPECIFICATIONS

Part Number	Description	Ports (In/Out)	Drains (FNPT)	Vents (FNPT)	Gauge Port (FNPT)	Swing Arm	Max. Flow (gpm)	Max. Flow (lpm)	Max. Flow (m ³ /hr)
HSBJ40-316	HydroScientific™ SB 40 Jumbo Filter Housing, ML, EP	2" FNPT	1"	1/4"	-	-	50	189	12
HSBJ90-316	HydroScientific™ SB 90 Jumbo Filter Housing, ML, EP	2" FNPT	1"	1/4"	-	-	100	378	24
HSBJ170-316	HydroScientific™ SB 170 Jumbo Filter Housing, ML, EP	2" FNPT	1"	1/4"	-	-	150	568	36
HSBJ170SB-3-316	HydroScientific™ SB 3 x 170 Jumbo Filter Housing, ML, EP	4" FL	11/2"	1/2"	1/2"	-	450	1703	102
HSBJ170SB-4-316	HydroScientific™ SB 4 x 170 Jumbo Filter Housing, ML, EP	6" FL	11/2"	1/2"	1/2"	-	600	2271	144
HSBJ170SB-5-316	HydroScientific™ SB 5 x 170 Jumbo Filter Housing, ML, EP	6" FL	11/2"	1/2"	1/2"	-	750	2839	170
HSBJ170SB-8-316	HydroScientific™ SB 8 x 170 Jumbo Filter Housing, ML, EP	6" FL	11/2"	1/2"	1/2"	-	1200	4542	272
HSBJ170SB-12-316	HydroScientific™ SB 12 x 170 Jumbo Filter Housing, ML, GB	12" FL	11/2"	1/2"	1/2"	✓	1800	6814	432
HSBJ170SB-16-316	HydroScientific™ SB 16 x 170 Jumbo Filter Housing, ML, GB	12" FL	2"	1/2"	1/2"	✓	2400	9085	576

SB = SWING BOLT, ML = LEGS, EP = ELECTROPOLISH, GB = GLASS BEAD, FL = FLANGE

SWING BOLT JUMBO FILTER HOUSINGS

HSBJ SERIES



APPLICATIONS

- Residential, Commercial, Industrial and Municipal
- Cooling Tower Filtration
- Whole House Filtration
- Process Water
- Well Water
- Small Community Compliance
- Industrial Waste Water Treatment

FEATURES

- 304 or 316 Stainless Steel.
- Electropolished standard on all models.
- Swing Bolt Design for Fast/Easy Operation.
- Stainless Steel Standpipe.
- Accepts Jumbo Style Cartridges.
- Multiple Size options to best meet your application.

ADDITIONAL FEATURES

Finish: Electropolished and Bead Blasted Standard
 Drains: Clean and Dirty standard on all models
 Gauge Ports: Clean and Dirty standard on all models

MATERIALS OF CONSTRUCTION

Housing Shell: 304 or 316 Stainless Steel
 Lid Closure: Zinc Plated Steel
 Vent and Drain Plugs: 304 or 316 Stainless Steel
 Heavy Duty Mounting Legs: 304 or 316 Stainless Steel
 O-Ring/Gasket: EPDM - FDA Grade
 (Viton, Silicone and EPR Options)

OPERATIONAL DATA

Max. Working Pressure: 150 psi at 300 °F (10.3 bar at 149 °C)
 Max. Operating Temperature: 300 °F (149 °C)

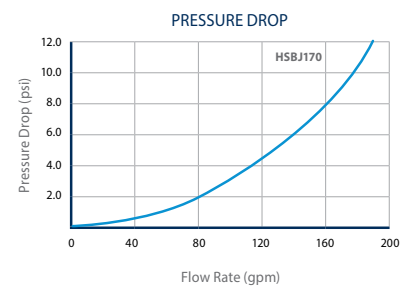
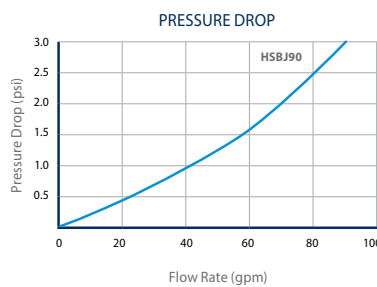
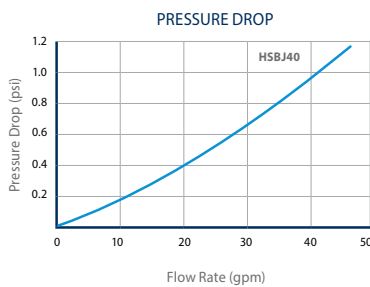
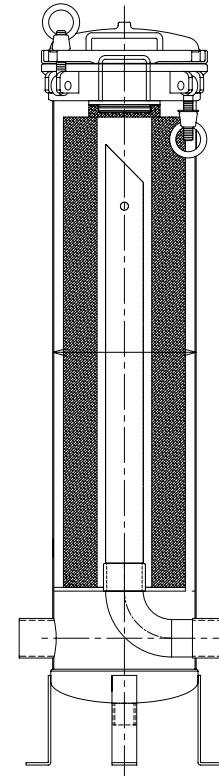
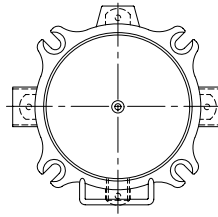



SWING BOLT MULTI ROUND FILTER HOUSINGS

MRH / MRHS SERIES



HYDROSCIENTIFIC™ MRH / MRHS SERIES - SWING BOLT MULTI ROUND FILTER HOUSINGS

are ideal for most industrial/commercial applications with our welded leg design as a standard, (not "optional") feature, we eliminate the added expense to your application. MRH/MRHS Swing Bolt Multi Round Housings are commonly used for pre-filtration for Reverse Osmosis (RO) systems, food service, car washes, agriculture and many other uses.

HYDROSCIENTIFIC™ MRH / MRHS SERIES - SWING BOLT MULTI ROUND FILTER HOUSINGS

are made with a high grade 304 or 316 Stainless Steel as standard and accept a wide range of filter cartridges.



HYDROSCIENTIFIC™ MRH SERIES - 304SS SWING BOLT MULTI ROUND FILTER HOUSING SPECIFICATIONS

Part Number	Description	Ports (In/Out)	Drains (FNPT/MNPT)	Gauge Port	Max. Flow (gpm)	Max. Flow (lpm)	Max. Flow (m ³ /hr)	No. of Cartridges
MRH-410-2	HydroScientific™ SB 4 x 10" Multi Filter Housing, ML, EP	2" FNPT	3/4" MNPT	1/4" FNPT	28	106	6	4
MRH-420-2	HydroScientific™ SB 4 x 20" Multi Filter Housing, ML, EP	2" FNPT	3/4" MNPT	1/4" FNPT	56	212	13	4
MRH-430-2	HydroScientific™ SB 4 x 30" Multi Filter Housing, ML, EP	2" FNPT	3/4" MNPT	1/4" FNPT	84	318	19	4
MRH-440-2	HydroScientific™ SB 4 x 40" Multi Filter Housing, ML, EP	2" FNPT	3/4" MNPT	1/4" FNPT	112	424	25	4
MRH-510-2	HydroScientific™ SB 5 x 10" Multi Filter Housing, ML, EP	2" FNPT	3/4" MNPT	1/4" FNPT	35	132	8	5
MRH-520-2	HydroScientific™ SB 5 x 20" Multi Filter Housing, ML, EP	2" FNPT	3/4" MNPT	1/4" FNPT	70	265	16	5
MRH-530-2	HydroScientific™ SB 5 x 30" Multi Filter Housing, ML, EP	2" FNPT	3/4" MNPT	1/4" FNPT	105	397	24	5
MRH-540-2	HydroScientific™ SB 5 x 40" Multi Filter Housing, ML, EP	2" FNPT	3/4" MNPT	1/4" FNPT	140	530	32	5
MRH-710-2	HydroScientific™ SB 7 x 10" Multi Filter Housing, ML, EP	2" FNPT	3/4" MNPT	1/4" FNPT	49	185	11	7
MRH-720-2	HydroScientific™ SB 7 x 20" Multi Filter Housing, ML, EP	2" FNPT	3/4" MNPT	1/4" FNPT	98	371	22	7
MRH-730-2	HydroScientific™ SB 7 x 30" Multi Filter Housing, ML, EP	2" FNPT	3/4" MNPT	1/4" FNPT	147	556	33	7
MRH-740-2	HydroScientific™ SB 7 x 40" Multi Filter Housing, ML, EP	2" FNPT	3/4" MNPT	1/4" FNPT	196	742	45	7
MRH-1230-3FL	HydroScientific™ SB 12 x 30" Multi Filter Housing, ML, EP	3" FL	1" FNPT	1/4" FNPT	252	954	57	12
MRH-1240-3FL	HydroScientific™ SB 12 x 40" Multi Filter Housing, ML, EP	3" FL	1" FNPT	1/4" FNPT	336	1272	76	12
MRH-2230-4FL	HydroScientific™ SB 22 x 30" Multi Filter Housing, ML, EP	4" FL	1" FNPT	1/2" FNPT	462	1749	105	22
MRH-2240-4FL	HydroScientific™ SB 22 x 40" Multi Filter Housing, ML, EP	4" FL	1" FNPT	1/2" FNPT	616	2332	140	22
MRH-3630-6FL	HydroScientific™ SB 36 x 30" Multi Filter Housing, ML, GB	6" FL	1" FNPT	1/2" FNPT	756	2862	172	36
MRH-3640-6FL	HydroScientific™ SB 36 x 40" Multi Filter Housing, ML, GB	6" FL	1" FNPT	1/2" FNPT	1008	3816	229	36
MRH-5230-6FL	HydroScientific™ SB 52 x 30" Multi Filter Housing, ML, GB	6" FL	1" FNPT	1/2" FNPT	1092	4134	248	52
MRH-5240-6FL	HydroScientific™ SB 52 x 40" Multi Filter Housing, ML, GB	6" FL	1" FNPT	1/2" FNPT	1456	5512	331	52
MRH-8530-8FL	HydroScientific™ SB 85 x 30" Multi Filter Housing, ML, GB	8" FL	1" FNPT	1/2" FNPT	1785	6757	405	85
MRH-8540-8FL	HydroScientific™ SB 85 x 40" Multi Filter Housing, ML, GB	8" FL	1" FNPT	1/2" FNPT	2380	9009	649	85

SB = SWING BOLT, ML = LEGS, EP = ELECTROPOLISH, GB = GLASS BEAD

SWING BOLT MULTI ROUND FILTER HOUSINGS

MRH / MRHS SERIES



HYDROSCIENTIFIC™ MRHS SERIES - 316SS SWING BOLT MULTI ROUND FILTER HOUSING SPECIFICATIONS								
Part Number	Description	Ports (In/Out)	Drains (FNPT/ MNPT)	Gauge Port	Max. Flow (gpm)	Max. Flow (lpm)	Max. Flow (m ³ /hr)	No. of Cartridges
MRHS-410-2	HydroScientific™ SB 4 x 10" Multi Filter Housing, ML, EP	2" FNPT	3/4" MNPT	1/4" FNPT	28	106	6	4
MRHS-420-2	HydroScientific™ SB 4 x 20" Multi Filter Housing, ML, EP	2" FNPT	3/4" MNPT	1/4" FNPT	56	212	13	4
MRHS-430-2	HydroScientific™ SB 4 x 30" Multi Filter Housing, ML, EP	2" FNPT	3/4" MNPT	1/4" FNPT	84	318	19	4
MRHS-440-2	HydroScientific™ SB 4 x 40" Multi Filter Housing, ML, EP	2" FNPT	3/4" MNPT	1/4" FNPT	112	424	25	4
MRHS-510-2	HydroScientific™ SB 5 x 10" Multi Filter Housing, ML, EP	2" FNPT	3/4" MNPT	1/4" FNPT	35	132	8	5
MRHS-520-2	HydroScientific™ SB 5 x 20" Multi Filter Housing, ML, EP	2" FNPT	3/4" MNPT	1/4" FNPT	70	265	16	5
MRHS-530-2	HydroScientific™ SB 5 x 30" Multi Filter Housing, ML, EP	2" FNPT	3/4" MNPT	1/4" FNPT	105	397	24	5
MRHS-540-2	HydroScientific™ SB 5 x 40" Multi Filter Housing, ML, EP	2" FNPT	3/4" MNPT	1/4" FNPT	140	530	32	5
MRHS-710-2	HydroScientific™ SB 7 x 10" Multi Filter Housing, ML, EP	2" FNPT	3/4" MNPT	1/4" FNPT	49	185	11	7
MRHS-720-2	HydroScientific™ SB 7 x 20" Multi Filter Housing, ML, EP	2" FNPT	3/4" MNPT	1/4" FNPT	98	371	22	7
MRHS-730-2	HydroScientific™ SB 7 x 30" Multi Filter Housing, ML, EP	2" FNPT	3/4" MNPT	1/4" FNPT	147	556	33	7
MRHS-740-2	HydroScientific™ SB 7 x 40" Multi Filter Housing, ML, EP	2" FNPT	3/4" MNPT	1/4" FNPT	196	742	45	7
MRHS-1230-3FL	HydroScientific™ SB 12 x 30" Multi Filter Housing, ML, EP	3" FL	1" FNPT	1/4" FNPT	252	954	57	12
MRHS-1240-3FL	HydroScientific™ SB 12 x 40" Multi Filter Housing, ML, EP	3" FL	1" FNPT	1/4" FNPT	336	1272	76	12
MRHS-2230-4FL	HydroScientific™ SB 22 x 30" Multi Filter Housing, ML, EP	4" FL	1" FNPT	1/2" FNPT	462	1749	105	22
MRHS-2240-4FL	HydroScientific™ SB 22 x 40" Multi Filter Housing, ML, EP	4" FL	1" FNPT	1/2" FNPT	616	2332	140	22
MRHS-3630-6FL	HydroScientific™ SB 36 x 30" Multi Filter Housing, ML, GB	6" FL	1" FNPT	1/2" FNPT	756	2862	172	36
MRHS-3640-6FL	HydroScientific™ SB 36 x 40" Multi Filter Housing, ML, GB	6" FL	1" FNPT	1/2" FNPT	1008	3816	229	36
MRHS-5230-6FL	HydroScientific™ SB 52 x 30" Multi Filter Housing, ML, GB	6" FL	1" FNPT	1/2" FNPT	1092	4134	248	52
MRHS-5240-6FL	HydroScientific™ SB 52 x 40" Multi Filter Housing, ML, GB	6" FL	1" FNPT	1/2" FNPT	1456	5512	331	52
MRHS-8530-8FL	HydroScientific™ SB 85 x 30" Multi Filter Housing, ML, GB	8" FL	1" FNPT	1/2" FNPT	1785	6757	405	85
MRHS-8540-8FL	HydroScientific™ SB 85 x 40" Multi Filter Housing, ML, GB	8" FL	1" FNPT	1/2" FNPT	2380	9009	649	85

SB = SWING BOLT, ML = LEGS, EP = ELECTROPOLISH, GB = GLASS BEAD

APPLICATIONS

- Residential, Commercial, Industrial, and Municipal
- Reverse Osmosis Pre-filtration
- Ground Water Remediation
- Industrial Process (High Purity) Applications
- Cooling Tower Filtration
- Process Water
- Industrial Waste Water Treatment

FEATURES

- Electropolished/Glass Bead 304 or 316 Stainless Steel.
- Swing Bolt Design for Safe/Easy Operation.
- Accepts DOE, 222/Flat or 222/Fin Cartridges.
- Heavy duty legs included on all models.
- Vented lid and Clean and Dirty Drains on all models.
- Two gauge ports on inlet and outlet on all models.
- Flow rates up to 2,380 gpm - 9,009 lpm - 649 m³/hr.

ADDITIONAL FEATURES

Finish: Electropolished and Bead Blasted Standard
 Drains: Clean and Dirty standard on all models
 Gauge Ports: Clean and Dirty standard on all models
 Cartridge Types: MRH DOE Style Cartridges (2-3/4" max. dia.)
 All MRH Filter Housings will accept DOE, 222/Flat or 222/Fin Cartridges Standard

MATERIALS OF CONSTRUCTION

Housing Shell: 304 or 316 Stainless Steel
 Lid Closure: Zinc Plated Steel
 Vent and Drain Plugs: 304 or 316 Stainless Steel
 Heavy Duty Mounting Legs: 304 or 316 Stainless Steel
 O-Ring/Gasket: EPDM - FDA Grade
 (Vitron, Silicone and EPR Options)

OPERATIONAL DATA

Max. Working Pressure: 150 psi at 300 °F (10.3 bar at 149 °C)
 Max. Operating Temperature: 300 °F (149 °C)



STAINLESS STEEL FILTER HOUSINGS

SC SERIES



HYDROSCIENTIFIC SCICLONE™ SERIES SS FILTER HOUSING

provide an exceptional performance housing design that helps separate dense solids prior to water passing through the filter cartridge. This SCICLONIC™ design delivers extended filter life, low cost operation, increased dirt holding capacity and reduced maintenance costs.

HYDROSCIENTIFIC SCICLONE™ SERIES SS FILTER HOUSING

come with Stainless Steel standpipes as a standard feature and through their SCICLONIC™ radial flow water entry, water enters the housing to create a cyclonic effect to prevent air entrapment and force water more effectively through the cartridges pleated filter media.



SC SCICLONE™ SERIES - 304SS SWING BOLT JUMBO FILTER HOUSING SPECIFICATIONS

Part Number	Description	Ports (In/Out)	Drains (FNPT)	Vents (FNPT)	Gauge Port	Swing Arm	Max. Flow (gpm)	Max. Flow (lpm)	Max. Flow (m ³ /hr)
SC40SB	HydroScientific Sciclone™ SB 40 Single Jumbo Filter Housing, ML, EP	2" FL	3/4"	1/2"	1/4"	-	50	189	12
SC90SB	HydroScientific Sciclone™ SB 90 Single Jumbo Filter Housing, ML, EP	2" FL	3/4"	1/2"	1/4"	-	100	378	24
SC170SB	HydroScientific Sciclone™ SB 170 Single Jumbo Filter Housing, ML, EP	2" FL	3/4"	1/2"	1/4"	-	150	568	36
SC170SB-3	HydroScientific Sciclone™ SB 3 x 170 Multi Jumbo Filter Housing, ML, EP	4" FL	1 1/2"	1/2"	1/2"	✓	450	1703	102
SC170SB-4	HydroScientific Sciclone™ SB 4 x 170 Multi Jumbo Filter Housing, ML, EP	6" FL	1 1/2"	1/2"	1/2"	✓	600	2271	144
SC170SB-5	HydroScientific Sciclone™ SB 5 x 170 Multi Jumbo Filter Housing, ML, EP	6" FL	1 1/2"	1/2"	1/2"	✓	750	2839	170
SC170SB-8	HydroScientific Sciclone™ SB 8 x 170 Multi Jumbo Filter Housing, ML, GB	6" FL	1 1/2"	1/2"	1/2"	✓	1200	4542	272
SC170SB-12	HydroScientific Sciclone™ SB 12 x 170 Multi Jumbo Filter Housing, ML, GB	12" FL	1 1/2"	1/2"	1/2"	✓	1800	6814	432
SC170SB-16	HydroScientific Sciclone™ SB 16 x 170 Multi Jumbo Filter Housing, ML, GB	12" FL	2"	1/2"	1/2"	✓	2400	9085	576

SC SCICLONE™ SERIES - 316SS SWING BOLT JUMBO FILTER HOUSING SPECIFICATIONS

Part Number	Description	Ports (In/Out)	Drains (FNPT)	Vents (FNPT)	Gauge Port	Swing Arm	Max. Flow (gpm)	Max. Flow (lpm)	Max. Flow (m ³ /hr)
SC40SB-316	HydroScientific Sciclone™ SB 40 Single Jumbo Filter Housing, ML, EP	2" FL	3/4"	1/2"	1/4"	-	50	189	12
SC90SB-316	HydroScientific Sciclone™ SB 90 Single Jumbo Filter Housing, ML, EP	2" FL	3/4"	1/2"	1/4"	-	100	378	24
SC170SB-316	HydroScientific Sciclone™ SB 170 Single Jumbo Filter Housing, ML, EP	2" FL	3/4"	1/2"	1/4"	-	150	568	36
SC170SB-3-316	HydroScientific Sciclone™ SB 3 x 170 Multi Jumbo Filter Housing, ML, EP	4" FL	1 1/2"	1/2"	1/2"	✓	450	1703	102
SC170SB-4-316	HydroScientific Sciclone™ SB 4 x 170 Multi Jumbo Filter Housing, ML, EP	6" FL	1 1/2"	1/2"	1/2"	✓	600	2271	144
SC170SB-5-316	HydroScientific Sciclone™ SB 5 x 170 Multi Jumbo Filter Housing, ML, EP	6" FL	1 1/2"	1/2"	1/2"	✓	750	2839	170
SC170SB-8-316	HydroScientific Sciclone™ SB 8 x 170 Multi Jumbo Filter Housing, ML, GB	6" FL	1 1/2"	1/2"	1/2"	✓	1200	4542	272
SC170SB-12-316	HydroScientific Sciclone™ SB 12 x 170 Multi Jumbo Filter Housing, ML, GB	12" FL	1 1/2"	1/2"	1/2"	✓	1800	6814	432
SC170SB-16-316	HydroScientific Sciclone™ SB 16 x 170 Multi Jumbo Filter Housing, ML, GB	12" FL	2"	1/2"	1/2"	✓	2400	9085	576

SB = SWING BOLT, ML = LEGS, EP = ELECTROPOLISH, GB = GLASS BEAD

STAINLESS STEEL FILTER HOUSINGS

SC SERIES



FEATURES

- SCICLONIC™ Water Flow Design.
- Swing bolt closure for quick and secure filter change.
- Heavy duty 304 or 316 Stainless Steel for durability available.
- Legs and Electropolish are standard.
- Accepts Jumbo Style Cartridges.
- Radial Flow Entry.
- Stainless Steel Standpipes.

APPLICATIONS

- Residential, Commercial, Industrial and Municipal
- Cooling Tower Filtration
- Whole House Filtration
- Process Water
- Well Water
- Small Community Compliance
- Industrial Waste Water Treatment

ADDITIONAL FEATURES

Finish:	Electropolished and Bead Blasted Standard
Drains:	Clean and Dirty standard on all models
Gauge Ports:	Clean and Dirty standard on all models

MATERIALS OF CONSTRUCTION

Housing Shell:	304 or 316 Stainless Steel
Swing Bolt Lid Closure:	Zinc Plated Steel
Vent and Drain Plugs:	304 or 316 Stainless Steel
Heavy Duty Mounting Legs:	304 or 316 Stainless Steel
O-Ring / Gasket:	EPDM - FDA Grade (Viton, Silicone and EPR Options)

OPERATIONAL DATA

Max. Working Pressure:	150 psi at 300 °F (10.3 bar at 149 °C)
Max. Operating Temperature:	300 °F (149 °C)

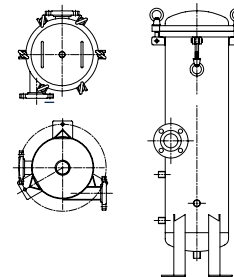
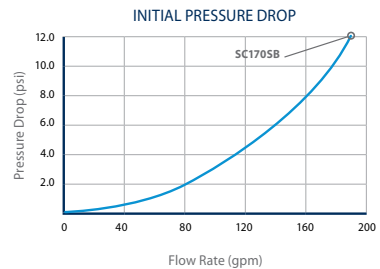
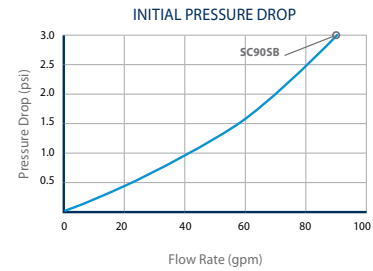
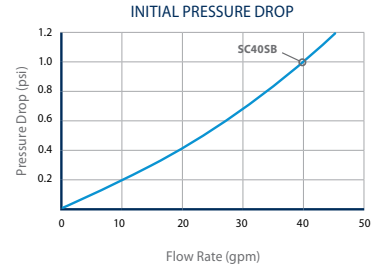
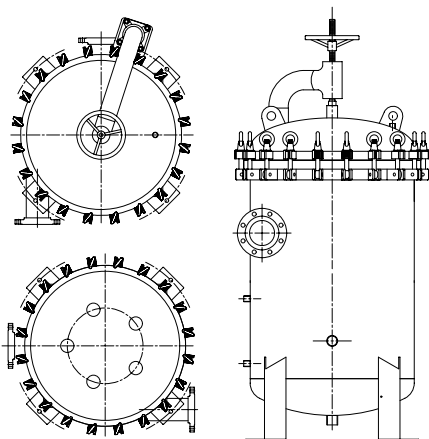

SPV SERIES

SS Membrane Vessels
Data Sheet

SPV Series

SS Membrane Vessels

- ✓ 21", 40", 80" Lengths Available
- ✓ 304 and 316** Stainless Steel Available
- ✓ 2.5" and 4" diameter
- ✓ End and Side Port



SPV SERIES S.S. MEMBRANE VESSELS

are your best choice for a quality membrane vessel. High quality, durability, flawless finish are but a few features which make the SPV Series Membrane Vessel the best product in the market. Accurate dimensions and precise tolerances equal a perfectly engineered product that not only meets your requirements but fits your price expectations.

SPV SERIES S.S. MEMBRANE VESSELS

have clamp closures that form tightly onto the vessel ends and incorporate glass reinforced Polyimide caps to provide a strong and tight seal.

SPV SERIES SPECIFICATIONS												
	Part Number	Size	Feed	Permeate	Housing	End Caps	Style	Type	Pressure	Qty	Weight (lbs)	Weight (kgs)
MEMBRANE VESSELS	SPV-2521	2.5" x 21"	3/8"	3/8"	304	GRP	End Port	U-Clamp	300 PSI	1	9	4.08
	SPV-2540	2.5" x 40"	3/8"	3/8"	304	GRP	End Port	U-Clamp	300 PSI	1	11	4.99
	SPV-4021-12	4" x 21"	1/2"	1/2"	304	GRP	End Port	U-Clamp	300 PSI	1	14	6.35
	SPV-4040-12	4" x 40"	1/2"	1/2"	304	GRP	End Port	U-Clamp	300 PSI	1	20	9.07
	SPV-4040-34	4" x 40"	3/4"	1/2"	304	GRP	End Port	U-Clamp	300 PSI	1	20	9.07
	SPV-4040SP	4" x 40"	3/4"	1/2"	304	GRP	Side Port	U-Clamp	300 PSI	1	19	8.62
	SPV-4043	4" x 43"	3/4"	1/2"	304	GRP	End Port	U-Clamp	300 PSI	1	21	9.53
	SPV-4061	4" x 61"	3/4"	1/2"	304	GRP	End Port	U-Clamp	300 PSI	1	24	10.89
	SPV-4080*	4" x 80"	3/4"	1/2"	304	GRP	End Port	U-Clamp	300 PSI	1	30	13.61
	SPV-4080SP	4" x 80"	3/4"	1/2"	304	GRP	Side Port	U-Clamp	300 PSI	1	30	13.61

*SPV-4080 will include both SPV-40 COUPLER and SPV-40CPLR for customer's choice. **Also available in 316 Stainless Steel material upon special request.

SPV SERIES

Stainless Steel Membrane Vessels
Data Sheet

SPV SERIES ACCESSORIES	
Part Number	Description
SPV-25CAP	End Cap Black for 2.5" RO Vessel
SPV-25CLMPKIT	Clamp Set for 2.5" RO Vessel
SPV-25CAPORING	Cap O-Ring for 2.5" RO Vessel
SPV-40CAPORING	Cap O-Ring for 4.0" RO Vessel
SPV-40CAP12	End Cap Black for 4" RO Vessel 1/2" Feed Port, 1/2" Brine
SPV-40CAP34	End Cap Black for 4" RO Vessel 3/4" Feed Port, 1/2" Brine
SPV-40CHNLCLMP	Channel Clamp for 4" RO Vessel
SPV-40CLMPKIT	Clamp Set for 4" RO Vessel
SPV-40COUPLER	Coupler for 4" Membrane
SPV-40CPLR-SP	Coupler for 4" Side Port
SPV-ORING	Permeate O-Ring for 2.5" & 4" SPV End Cap

SPV-4040-12
Front View

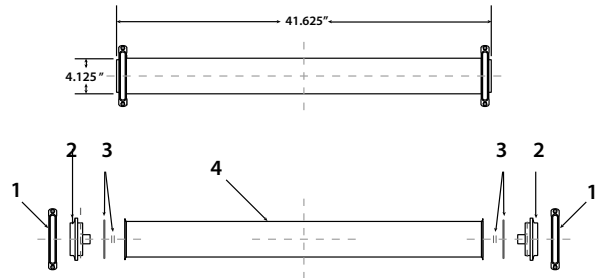

LEGEND

- 1) Clamps
- 2) Cap
- 3) O-Rings
- 4) Vessel

Materials of Construction

Body: 304 and 316** Stainless Steel
End Caps: Glass Reinforced Polyimide
O-rings/Packing: EPDM

Model # Guide

Sediment Bonded Depth Cartridge	Length	Sediment Bonded Depth Cartridge	Length	Feed
SPV-2521		SPV-4021-12		
Outside Diameter		Outside Diameter	Feed	

LEGEND

Outside Diameter:	25 = 2.5" 40 = 4"	Length:	21 = 21" 40 = 40" 43 = 43" 61 = 61" 80 = 80"	Feed:	12 = 1/2" 34 = 3/4"	Style:	SP = Side Port
-------------------	----------------------	---------	--	-------	------------------------	--------	----------------



SPV-40CLMPKIT



SPV-40CAP12

Distributed by:



3001 S.W. 15th Street, Suite C, Deerfield Beach, FL 33442
sales@h2ofilter.com • www.h2ofilter.com
Toll-Free Number: 1-800-570-3464
International: 1-954-570-3464

T SERIES*Stainless Steel Single Element Filter Housings
Data Sheet***T Series***Stainless Steel Single Element Filter Housings*

- ✓ Offered in Double Open End configurations
- ✓ 304 or 316 Stainless Steel Construction
- ✓ 150 PSI (10.3 bar) Pressure Rating
- ✓ Electro-polished finish

**T SERIES SINGLE ELEMENT FILTER HOUSINGS**

are designed with a double o-ring compression which allows for positive sealing and easy access. Knife edge seal at both cartridge ends to eliminate by-pass for DOE cartridges and In-line design for easy installation.

T SERIES SPECIFICATIONS						
Part Number	Description	Flow Rate (GPM)	Flow Rate (LPM)	Case Qty	Weight (lbs)	Weight (kgs)
T1-304-34	10", 304 SS Filter Housing, 3/4" FNPT (T1)	5	18.9	1	9	4.08
T2-304-34	10", 304 SS Filter Housing, 3/4" FNPT (T2)	10	37.8	1	12	5.44
T1-316-34	10", 316 SS Filter Housing, 3/4" FNPT (T1)	5	18.9	1	9	4.08
T2-316-34	10", 316 SS Filter Housing, 3/4" FNPT (T2)	10	37.8	1	12	5.44



Standard Features

- Electro-polished finish
- Includes 1/8" NPT vent and 1/8" NPT drain

Materials of Construction

Housing:	304 or 316 stainless steel
Closure:	Stainless Steel
O-Ring:	Silicone (standard)
Max. Pressure/Temp:	150 PSI at 250°F (10.3 bar at 10.3°C) Filter Housing Only



Applications

- Food & Beverage Filtration
- Reverse Osmosis Pre-filtration
- Process Water Filtration
- Cutting Fluids
- Plating Solutions
- High Purity Water
- Lubricants
- Inks

Pressure Drop

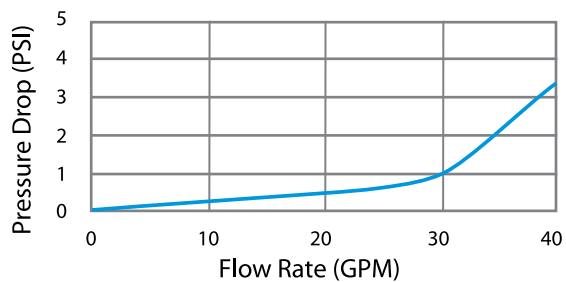

Pressure Drop based on 3/4" and 1" inlet/outlet housings, without cartridges.

Distributed by:



3001 S.W. 15th Street, Suite C, Deerfield Beach, FL 33442
sales@h2ofilter.com • www.h2ofilter.com

Toll-Free Number: 1-800-570-3464

International: 1-954-570-3464



FRPV-40 - DATA SHEET

HYDRON 4" FRPV MEMBRANE HOUSING

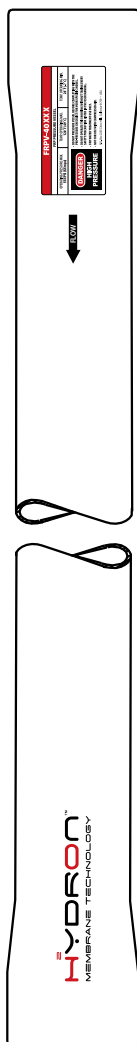

FRPV-40 OUTER DIAMETER

BODY: $\varnothing 4.25" + 0.07"$
(108 mm + 2 mm)

HEAD: $\varnothing 4.80" + 0.07"$
(122 mm + 2 mm)

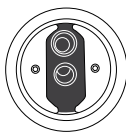

CAUTION
EYE PROTECTION SHOULD BE WORN WHEN REMOVING OR INSTALLING RETAINING RINGS. KEEP FINGERS CLEAR FROM RETAINING RING WHILE INSTALLING LAST OF TWO TURNS. RING MAY SNAP INTO POSITION POSSIBLY PINCHING FINGERS.



HYDRON 4" FRPV Series II Membrane Housings are durable composite reinforced membrane vessels designed for use in commercial and industrial Reverse Osmosis systems. FRPV vessels are coated with high gloss polyurethane paint to provide resistance to UV rays and other elements.

HYDRON 4" FRPV Series II Membrane Housings can accommodate any standard 40" membrane element, have a compact design and offer a reliable head seal area. Hydron FRPV membrane housings are made to meet the demands of long term and continuous use.

- **High Gloss Polyurethane Exterior Coating for resistance to UV rays and other elements.**
- **Compact design for commercial and industrial reverse osmosis and ultrafiltration applications.**
- **Accommodates all standard 4"x40" membrane elements.**
- **Manufactured to meet the demands of long term and continuous use.**
- **Locking plate with allen head bolts for easy maintenance and safety.**

INTENDED USE

The model FRPV-4030EF Fiberglass RO/UF Pressure Vessel is designed for continuous, long-term use as a housing for single reverse osmosis and ultrafiltration elements in typical commercial water treatment systems at pressures up to 300 psi.

Any make of 4"x40" nominal diameter spiral-wound element is easily accommodated.

The model FRPV-4030EF must be installed, operated and maintained in accordance with the listed precautions, and good industrial practice to assure safe operation over a long service life.

The high performance reinforced plastic shell must be allowed to expand under pressure; undue restraint at support points or piping connections can cause leaks to develop in the shell.

The end closure, incorporating close-fitting, interlocking metal components, must be kept dry and free of corrosion; deterioration can lead to catastrophic mechanical failure of the head assembly.

**Specifications subject to change without notice.*

4" FRPV Membrane Housing Specifications

Elements	Part Number	Maximum Operating Pressure	Maximum Operating Temperature	Minimum Operating Temperature	Inlet Port	Permeate Port
1	FRPV-4030EF	300 psi (21 bar)	150° F (66° C)	14° F (-10° C)	1/2"	1/2"
2	FRPV-403080EF	300 psi (21 bar)	150° F (66° C)	14° F (-10° C)	3/4"	1/2"
3	FRPV-4012030EF	300 psi (21 bar)	150° F (66° C)	14° F (-10° C)	3/4"	1/2"

PRECAUTIONS

DO... read, understand and follow all instructions; failure to take every precaution will void warranty and may result in vessel failure. DO... inspect end closures regularly; replace components that have deteriorated and correct causes of corrosion. DO... provide overpressure protection for vessel set at not more than 105% of design pressure. DO... mount shell on horizontal or vertical members at central span "S" using compliant, vessel supports; tighten hold down straps just snug. DO NOT... pressurize vessel until double checking to verify that the retaining rings are in place. DO NOT... work on any component until first verifying that pressure is relieved from vessel. DO NOT... tolerate leaks or allow end closures to be routinely wetted in any way. DO NOT... operate vessel with permeate pressure in excess of 125 psi at 120 °F (0.86 MPa at 49 °C). DO NOT... make rigid piping connections to parts or clamp vessel in any way that restricts growth of fiberglass shell under pressure; ▲DIA = 0.01 in. (0.25mm) and ▲L = 0.3 in. (.8mm) for a length code -1 vessel. DO NOT... hang piping manifolds from parts or use vessel in any way to support other components. DO NOT ... operate at pH levels below 3 or above 11. DO NOT... operate vessel at pressures and temperatures in excess of its rating.

Distributed by:



3001 S.W. 15th Street, Suite C, Deerfield Beach, FL 33442
sales@h2ofilter.com • www.h2ofilter.com

Toll-Free Number: 1-800-570-3464

International: 1-954-570-3464



FRPV-80 - DATA SHEET

HYDRON 8" FRPV MEMBRANE HOUSING

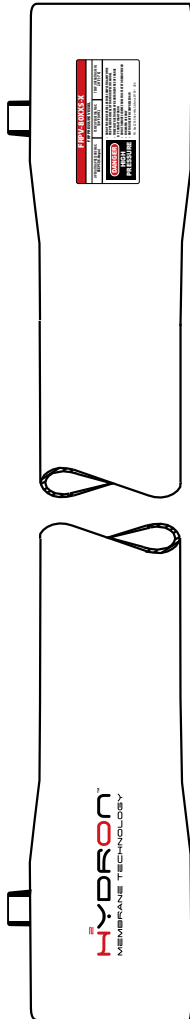

FRPV-8030 OUTER DIAMETER

BODY: Ø8.27" + 0.12"
(210 mm + 3 mm)

HEAD: Ø9.49" + 0.07"
(241 mm + 2 mm)

FRPV-8060 OUTER DIAMETER

BODY: Ø8.58" + 0.12"
(218 mm + 3 mm)

HEAD: Ø9.96" + 0.07"
(253 mm + 2 mm)



⚠ CAUTION ⚠
INCORRECT INSTALLATION, OPERATION AND MAINTENANCE OF THESE VESSELS MAY CAUSE LOSS OF LIFE, SEVER BODILY INJURY, AND OR PROPERTY DAMAGE.

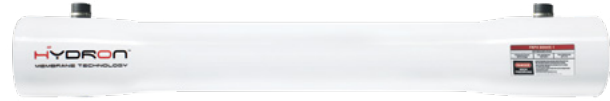

HYDRON 8" FRPV Series Membrane Housings are durable composite reinforced membrane vessels designed for use in commercial, municipal and industrial Reverse Osmosis systems. Hydron FRPV vessels are coated with high gloss polyurethane paint to provide resistance to UV rays and other elements and are available in 300 psi and 600 psi ratings.

HYDRON 8" FRPV Series Membrane Housings can accommodate any standard 8" x 40" membrane elements, have a compact design and offer a reliable head seal area. Hydron FRPV membrane housings are made to meet the demands of long term and continuous use.

- **High Gloss Polyurethane Exterior Coating for resistance to UV rays and other elements.**
- **Compact design for commercial, municipal and industrial reverse osmosis and ultrafiltration applications.**
- **Accommodates all standard 8"x40" membrane elements.**
- **Manufactured to meet the demands of long term and continuous use.**
- **Locking plate with secure head bolts for easy maintenance, safety and security.**

INTENDED USE

Hydron FRPV Membrane Housings are designed for continuous, long-term use as a housing for single and multiple reverse osmosis and ultrafiltration elements in typical commercial water treatment systems at pressures from 300 psi - 600 psi.

Hydron FRPV Membrane Housings must be installed, operated and maintained in accordance with the listed precautions, and good industrial practice to assure safe operation over a long service life.

The high performance reinforced plastic shell must be allowed to expand under pressure; undue restraint at support points or piping connections can cause leaks to develop in the shell.

The end closure, incorporating close-fitting, interlocking metal components, must be kept dry and free of corrosion; deterioration can lead to catastrophic mechanical failure of the head assembly.

** Specifications subject to change without notice.*

8" FRPV Membrane Housing Specifications

Elements	Part Number	Maximum Operating Pressure	Maximum Operating Temperature	Minimum Operating Temperature	Inlet Port	Permeate Port
1	FRPV-8030S-1	300 psi (21 bar)	150° F (66° C)	14° F (-10° C)	1.5"	1"
2	FRPV-8030S-2	300 psi (21 bar)	150° F (66° C)	14° F (-10° C)	1.5"	1"
3	FRPV-8030S-3	300 psi (21 bar)	150° F (66° C)	14° F (-10° C)	1.5"	1"
1	FRPV-8060S-1	600 psi (41 bar)	150° F (66° C)	14° F (-10° C)	1.5"	1"
2	FRPV-8060S-2	600 psi (41 bar)	150° F (66° C)	14° F (-10° C)	1.5"	1"
3	FRPV-8060S-3	600 psi (41 bar)	150° F (66° C)	14° F (-10° C)	1.5"	1"

Note: Available from 1-6 elements.

PRECAUTIONS

DO... read, understand and follow all instructions; failure to take every precaution will void warranty and may result in vessel failure or serious injury or death. DO... inspect end closures regularly; replace components that have deteriorated and correct causes of corrosion. DO... provide overpressure protection for vessel set at not more than 105% of design pressure. DO... mount shell on horizontal or vertical members at central span "S" using compliant, vessel supports; tighten hold down straps just snug. DO NOT... pressurize vessel until double checking to verify that the Locking Plates are in place. DO NOT... work on any component until first verifying that pressure is relieved from vessel. DO NOT... tolerate leaks or allow end closures to be routinely wetted in any way. DO NOT... operate vessel with permeate pressure in excess of 125 psi at 120 °F (0.86 MPa at 49 °C). DO NOT... make rigid piping connections to parts or clamp vessel in any way that restricts growth of fiberglass shell under pressure; ▲DIA = 0.01 in. (0.25mm) and ▲L = 0.3 in. (.8mm) for a length code -1 vessel. DO NOT... hang piping manifolds from parts or use vessel in any way to support other components. DO NOT... operate at pH levels below 3 or above 11. DO NOT... operate vessel at pressures and temperatures in excess of its rating.

Distributed by:



3001 S.W. 15th Street, Suite C, Deerfield Beach, FL 33442

sales@h2ofilter.com • www.h2ofilter.com

Toll-Free Number: 1-800-570-3464

International: 1-954-570-3464