

# Pumps

2023 - 2024



**Booster**



**Dosing**



**Jet Booster Pump**

[Click here to  
see Price List](#)

**H<sub>2</sub>O International Inc.**

3001 S.W. 15th St., Suite C, Deerfield Beach, FL 33442

USA Toll-Free: 1-800-570-3464      International: 1-954-570-3464

sales@h2ofilter.com      www.h2ofilter.com

# **Pumps**

## **Table Of Contents**



### **Booster Pumps – PMP Series**

- 1. PMP-100GPD**
- 2. PMP-50GPD**
- 3. PMP-300GPD**

### **Chemical Dosing Pumps – ADP Series**

- 1. 110V Dosing Pump**
- 2. 220V Dosing Pump**

### **Aquatrol Jet Booster Pumps – AQT-JBP Series**

- 1. 110/220V 0.5 HP**
- 2. 110/220V 1 HP**
- 3. 110/220V 1.5 HP**

# PMP100GPD

## BOOSTER PUMP



### PMP-100GPD SPECIFICATIONS

<b>MODEL NUMBER:</b>	PMP-100GPD
<b>PUMP DESIGN:</b>	Positive displacement
<b>DIAPHRAGM PUMP:</b>	Three chamber
<b>MOTOR:</b>	Permanent magnet
<b>VOLTAGE:</b>	24 VDC
<b>PRESSURE SWITCH:</b>	None
<b>LIQUID TEMPERATURE:</b>	140° F (60° C) max.
<b>PRIME:</b>	Self-priming up to 2 meter
<b>RUNS DRY:</b>	WITHOUT DAMAGE
<b>PORTS:</b>	3/8"-18 NPT female
<b>NET WEIGHT:</b>	4.67 lbs (2.12 kg)
<b>DUTY CYCLE:</b>	Continuous
<b>TYPICAL APPLICATIONS:</b>	R.O. booster pump and water delivery
<b>BYPASS:</b>	125 psi

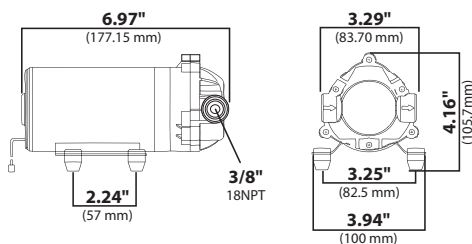

INLET - 8 PSI		
PRESSURE (PSI)	FLOW GPM / (L/min)	CURRENT (AMPS)
Open Flow	0.58 / 2.20	0.15
10	0.52 / 1.95	0.19
20	0.48 / 1.80	0.26
30	0.44 / 1.65	0.33
40	0.41 / 1.55	0.40
50	0.39 / 1.48	0.49
60	0.36 / 1.37	0.56
70	0.34 / 1.27	0.62
80	0.31 / 1.18	0.68
90	0.26 / 1.00	0.73
100	0.18 / 0.69	0.76
110	0.092 / 0.35	0.82
125	BY PASS	1.34

*All data based on testing with water | Voltage (Volts): 24 VDC/1.5A/ Adaptor*

NOTE: Performance will vary with variation in service voltage and transformer output

### Distributed by:



3001 S.W. 15th Street, Suite C, Deerfield Beach, FL 33442  
 sales@h2ofilter.com • www.h2ofilter.com

**Toll-Free Number:** 1-800-570-3464

**International:** 1-954-570-3464

# PMP-50GPD

## BOOSTER PUMP



### PMP-50GPD SPECIFICATIONS

<b>MODEL NUMBER:</b>	PMP-50GPD
<b>PUMP DESIGN:</b>	Positive displacement
<b>DIAPHRAGM PUMP:</b>	Three chamber
<b>MOTOR:</b>	Permanent magnet
<b>VOLTAGE:</b>	24 VDC
<b>PRESSURE SWITCH:</b>	None
<b>LIQUID TEMPERATURE:</b>	140° F (60° C) max.
<b>PRIME:</b>	Self-priming 1 meter
<b>RUNS DRY:</b>	WITHOUT DAMAGE
<b>PORTS:</b>	3/8"-18 NPT female
<b>NET WEIGHT:</b>	Plastic plate 3.76 lbs (1.70 kg) Iron plate 3.92 lbs (1.78 kg)
<b>DUTY CYCLE:</b>	Continuous
<b>TYPICAL APPLICATIONS:</b>	R.O. booster pump and water delivery
<b>BYPASS:</b>	120 psi

INLET - 8 PSI		
PRESSURE (PSI)	FLOW GPM / (L/min)	CURRENT (AMPS)
Open Flow	0.33 / 1.26	0.15
10	0.32 / 1.21	0.19
20	0.3 / 1.12	0.26
30	0.27 / 1.04	0.33
40	0.26 / 0.97	0.40
50	0.23 / 0.88	0.49
60	0.21 / 0.78	0.56
70	0.18 / 0.69	0.62
80	0.16 / 0.60	0.68
90	0.12 / 0.44	0.73
100	0.042 / 0.16	0.76
120	BY PASS	0.82

*All data based on testing with water | Voltage (Volts): 24 VDC/1.2A/Adaptor*

NOTE: Performance will vary with variation in service voltage and transformer output

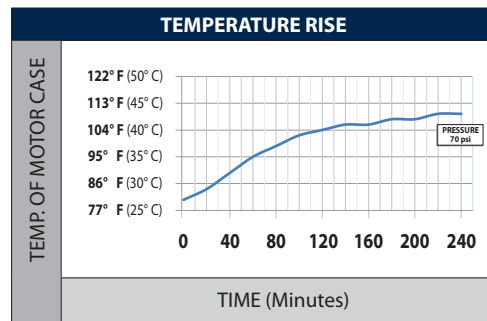
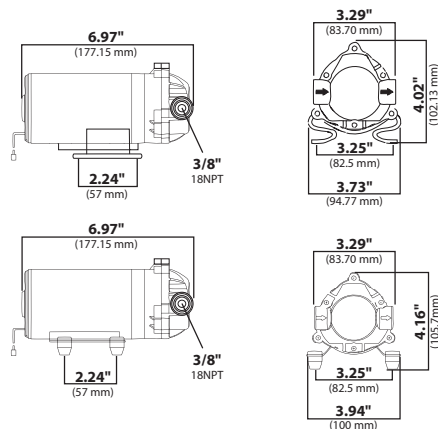

THIS TEST IS BASED ON RUNNING CONTINUOUSLY WITH AN AMBIENT TEMPERATURE OF 78.8°F (26°C) IN STILL AIR

Distributed by:



3001 S.W. 15th Street, Suite C, Deerfield Beach, FL 33442

sales@h2ofilter.com • www.h2ofilter.com

**Toll-Free Number:** 1-800-570-3464

**International:** 1-954-570-3464



# PMP-300GPD

## BOOSTER PUMP



### PMP-300GPD SPECIFICATIONS

<b>MODEL NUMBER:</b>	PMP-300GPD
<b>PUMP DESIGN:</b>	Positive displacement
<b>Diaphragm pump:</b>	Three Chamber
<b>MOTOR:</b>	Permanent magnet
<b>VOLTAGE:</b>	36VDC
<b>PRESSURE SWITCH:</b>	NONE
<b>LIQUID TEMPERATURE:</b>	140 °F (60 °C) max.
<b>PRIME:</b>	Self-priming up to 2 meter
<b>RUNS DRY:</b>	WITHOUT DAMAGE
<b>PORTS:</b>	3/8" - 18 NPT female
<b>NET WEIGHT:</b>	4.65 lbs (2.11 kg)
<b>WETTED PARTS:</b>	FDA food grade material
<b>TYPICAL APPLICATIONS:</b>	R.O. booster pump and water delivery

NOTE: RECOMMENDED SHUT OFF TEMPERATURE: 150 °F. (REQUIRED TO SHUT DOWN WHILE THE MOTOR COOLS DOWN.)

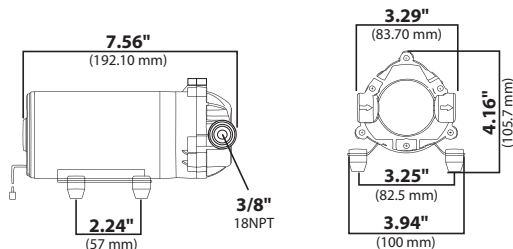

INLET - 15 PSI		
PRESSURE (PSI)	FLOW GPM /(L/min)	CURRENT (AMPS)
20	1.16 / 4.40	0.86
30	1.13 / 4.28	1.06
40	1.09 / 4.13	1.24
50	1.05 / 3.98	1.40
60	1.02 / 3.85	1.58
70	0.97 / 3.70	1.76
80	0.95 / 3.60	1.99
90	0.92 / 3.50	2.11
100	0.86 / 3.27	2.26

*All data based on testing with water  
Voltage (Volts): 36 VDC/1.5A/Adaptor*

NOTE: Performance will vary with variation in service voltage and transformer output

Distributed by:



3001 S.W. 15th Street, Suite C, Deerfield Beach, FL 33442  
sales@h2ofilter.com • www.h2ofilter.com

**Toll-Free Number:** 1-800-570-3464

**International:** 1-954-570-3464

# ADP SERIES

## CHEMDOSE CHEMICAL DOSING PUMPS



**Aquatrol ChemDose Chemical Dosing Pumps** are versatile, easy to use and easy to program pumps ideal for chlorine and a wide variety of chemical feed applications.

**Aquatrol ChemDose Chemical Dosing Pumps** are not only reliable, quiet and completely enclosed, the housing is chemical resistant and provides outstanding protection in outdoor or indoor applications. With its durable Teflon diaphragm and PTFE pump head you can rest assured that it will provide years of service with little to no maintenance. Stroke length and stroke speed can be manually adjusted and standard priming without removing tubing makes it easy to put into operation.

**Aquatrol ChemDose Chemical Dosing Pumps** give you the flexibility to dose from 6 gpd to 38 gpd with one single pump.

### CHEMICAL DOSING PUMP - SPECIFICATIONS

Part Number	Description
ADP-01141-1	AQUATROL™ Dosing Pump, 110V, 60/50 Hz
ADP-01141-2	AQUATROL™ Dosing Pump, 220V, 60/50 Hz

### CHEMICAL DOSING PUMP PARTS - SPECIFICATIONS

Part Number	Description
ADP-KOPKIT	Diaphragm and Head with Check Valves (output and inlet)
ADP-TUBKIT	AQUATROL™ Dosing Pump Tubing and Valves Replace Kit



# ADP SERIES

## CHEMDOSE CHEMICAL DOSING PUMPS

### PUMP SPECIFICATIONS

- Max. Capacity: 38 gpd (144 lpd)
- Pressure: 72.5 psi (5 bar)
- Power: 40 W
- Voltage: 110V or 220V
- Hertz: 50/60 Hz
- Flow: 1.6 gal/h (6 l/h)
- Max. Temperature: 104 °F (40 °C)
- Stroke per minute: 180
- Suction: 2 m
- IP55 protection
- Anticorrosive plastic casing
- Manual stroke frequency control
- Product weight: 4.85 lbs (2.2 kg)

### MATERIALS OF CONSTRUCTION

#### LIQUID ENDS MATERIALS:

- Diaphragm : TEFLON
- Pump head: PVC, PP, SS316, PTFE
- Suction and the delivery valve: PVC, PP, SS316, PTFE
- Filter: PP
- Injection valve: PP (G1/2")
- Suction tube: PVC, PE, PTFE
- Delivery tube: PVC, PE, PTFE
- Seals: FPM

### CHEMICAL COMPATIBILITY

The pump should be used to dose the liquid which has been expressly designed to dose. Chemical compatibility of this pump with the following solutions is rated as good. For chemicals not listed, please contact your local representative or the factory.

- |  |                            |
|--|----------------------------|
| » Alum                                 | » Calcium Hypochlorite     |
| » Muriatic Acid (5% Hydrochloric Acid) | » Polyphosphates           |
| » Potassium Permanganate, 10%          | » Sodium Bicarbonate       |
| » Sodium Carbonate                     | » Sodium Hydroxide         |
| » Sodium Hypochlorite                  | » Sodium Hexametaphosphate |
| » Sodium Phosphate                     | » Sodium Thiosulfate       |
| » Vinegar                              |                            |

Any other liquids should be confirmed with the manufacturer for suitability before use. Use of different liquids is considered improper and can represent a danger to the user and equipment. Improper liquids can damage the pump material can damage the pump or the operator. Aquatrol can help the user select the pump according to the characteristics of the liquid.

*Aquatrol will not be held responsible for damage deriving from improper use of the pump.*

### PUMP DIMENSIONS

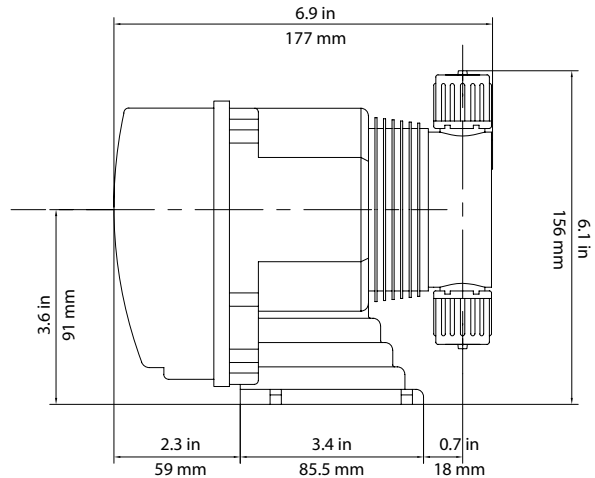

SIDE

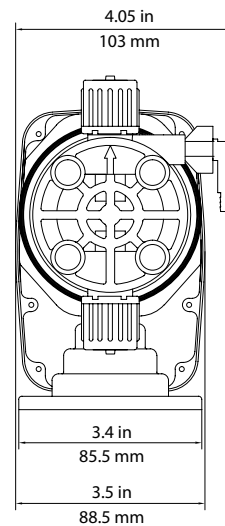

BACK

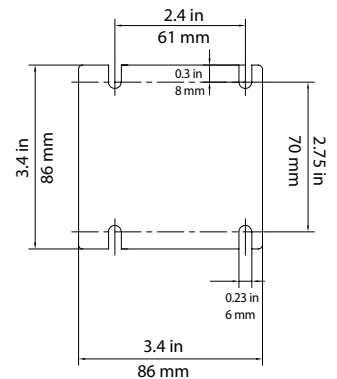

BASE

Distributed by:



3001 S.W. 15th Street, Suite C, Deerfield Beach, FL 33442

sales@h2ofilter.com • www.h2ofilter.com

**Toll-Free Number:** 1-800-570-3464

**International:** 1-954-570-3464



---

## AQT-JBP SERIES

---

### SELF PRIMING JET BOOSTER PUMP

---



**Aquatrol JBP Series Jet Booster Pumps** are a perfect choice for boosting water pressure in residential, commercial and light industrial applications where low or inadequate water pressure exists. They are ideal for boosting pressure in shallow well applications where the water level is less than 29.5 feet deep.

- 0.5, 0.75, 1 and 1.5 HP
- 69.6 psi maximum pressure
- Shallow Well Pumps up to a depth of 25 ft.
- For Domestic Water Supply or Boosting Applications
- Compact and reliable design - Trouble-Free Operation
- Easy To Install, Easy To Use, Quiet Operation
- Weatherproof Material – Can Be Placed Outdoors
- Perfect For Homes, Cottages, Farms and Greenhouses

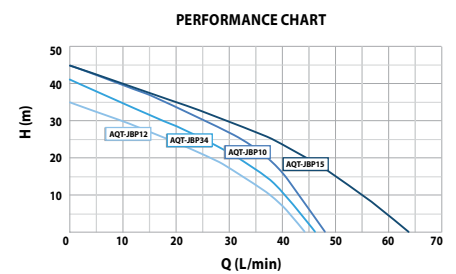

*This Performance Test is at n=2850 r/min*



# AQT-JBP SERIES

## SELF PRIMING JET BOOSTER PUMP

### JET BOOSTER PUMP SPECIFICATIONS

- VOLTAGE: 110V or 220V
- HERTZ: 50/60 Hz
- DISCHARGE SIZE: 1" FNPT
- MAX. SUCTION HEAD: 29.5 ft (9 m)
- LIQUID TEMPERATURE RANGE: 32 °F - 113 °F (0 °C - 40 °C)
- AQT-JBP12 WEIGHT: 17.6 lbs (8 kgs)
- AQT-JBP34, AQT-JBP10, AQT-JBP15 WEIGHT: 21 lbs (9.5 kgs)

### MATERIALS OF CONSTRUCTION

- PUMP BODY: 304 Stainless Steel
- NOZZLE & DIFFUSER: Plastic (PPO)
- IMPELLER: Polyphenylene Oxide (PPO)
- MECHANICAL SEAL: NBR, SS304, Ceramic and Carbon
- MOTOR: Closed
- PROTECTION: IP55

### CHEMICAL COMPATIBILITY

**CAUTION!** The Self Priming Jet Booster Pump should ONLY be used to pump water.

**DANGER!** Do not pump flammable or explosive liquids such as oil, gasoline, kerosene, ethanol, etc. Do not use in the presence of flammable or explosive vapors. Using this pump with or near flammable liquids can cause an explosion or fire, resulting in property damage, serious personal injury, and/or death.

Use of different liquids is considered improper and can represent a danger to the user and equipment. Improper liquids can damage the pump material can damage the pump or the operator.

*Aquatrol will not be held responsible for damage deriving from improper use of the pump.*

PERFORMANCE								
PART #	HP	GPM @ TOTAL DISCHARGE PRESSURE OF 40 PSI						MAXIMUM PRESSURE
		0 ft	5 ft	10 ft	15 ft	20 ft	25 ft	
AQT-JBP12	0.5	10.6	10.3	10.04	9.77	9.51	9.25	50.8 psi (3.5 bar)
AQT-JBP34	0.75	12.1	12.02	11.62	11.36	11.23	10.96	58.0 psi (4 bar)
AQT-JBP10	1.0	13.2	13	12.81	12.55	12.42	12.15	65.3 psi (4.5 bar)
AQT-JBP15	1.5	15.8	15.59	15.19	14.79	14.45	14.13	69.6 psi (4.8 bar)

### JET BOOSTER PUMP DIMENSIONS

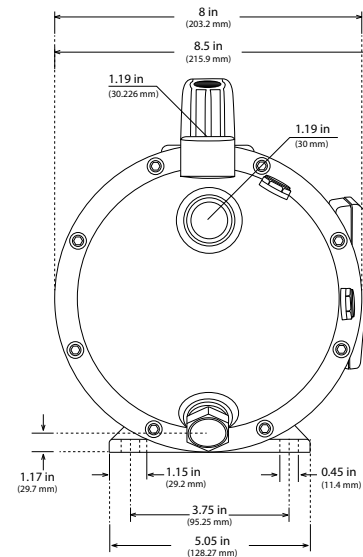
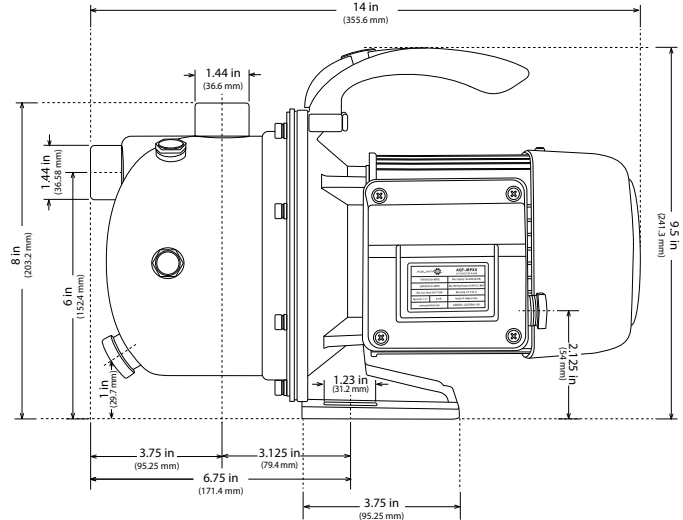

LIT-AQT-JBP-DS 09/09/20

Distributed by:



3001 S.W. 15th Street, Suite C, Deerfield Beach, FL 33442  
 sales@h2ofilter.com • www.h2ofilter.com  
**Toll-Free Number: 1-800-570-3464**  
**International: 1-954-570-3464**